

Amended Plat of:
Lots 169 and 170 of The Wilderness Club, Phase 2
NW 1/4 Section 33, T37N R27W, P.M., M.
Lincoln County, Montana

For: James & Nancy Shepard Trust
Owner: James & Nancy Shepard Trust
Date: 12 April, 2022
Purpose: Aggregation



PERIMETER DESCRIPTION
That portion of the Northwest 1/4 of Section 33, Township 37 North Range 27 West, Principal Meridian, Montana, Lincoln County, Montana described as follows:
Lots 169 and 170 of The Wilderness Club, Phase 2
Containing 1.18 acres of land as shown hereon.

I hereby certify that this division (Lot 169A) is for the purpose of aggregating lots. A restriction or requirement on the original platted lot or original unplatted parcel continues to apply to those areas. Therefore, pursuant to 76-3-207 (1) (f) this division is exempt from review as a subdivision.

We also hereby certify that this parcel is exempt from the Sanitation Act review under MCA 76-4-125 (1) (a), aggregation of parcels or lots when a certificate of survey or subdivision plat shows that the boundaries of the original parcels have been eliminated and the boundaries of a larger aggregate parcel are established. A restriction or requirement on the original platted lot or original unplatted parcel continues to apply to those areas.

[Signature] Aug. 14, 2023
James W. Shepard
Trustee for James & Nancy Shepard Trust
[Signature] Aug. 14, 2023
Nancy T. Shepard
Trustee for James & Nancy Shepard Trust

STATE OF Montana
County of Lincoln ss.

This instrument was acknowledged before me on 8/14, 2023
by James W. Shepard and Nancy T. Shepard for James & Nancy Shepard Trust.

[Signature]
Notary Public

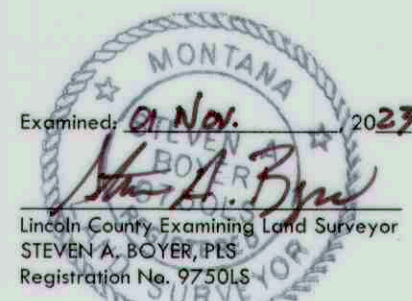
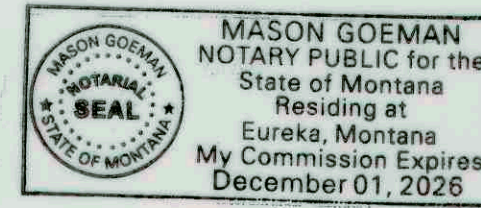

CERTIFICATE OF SURVEYOR
[Signature] 7-12-23
Andrew Belts, PLS
Registration No. 14731 PLS
Date

Legend
⊙ found 8" rebar
"Marquardt 7328"
* record course per Wilderness Club, Phase 2

SCALE
0' 15' 30'
Basis of Bearing is NAD83 (2011) Montana State Plane Grid.
Distances are International Feet at ground based on:
Latitude: N48°55'40.04097"
Longitude: W115°08'21.80995"
Ellipsoidal Height: 2552.356
Combined Scale Factor: 1.0001655493
Convergence: -004°07'30.86"



236 Wisconsin Ave., 311 SW Jefferson Avenue
Whitefish, MT 59917 Corvallis, OR 97333
Tel: 406.862.4927 Tel: 541.738.2920
Fax: 406.862.4993 Fax: 541.738.8324

NOTE: No search has been made for easements effecting this property and this survey does not purport to show all appurtenant easements.



I hereby certify that all real property taxes and special assessments assessed and levied on the land to be divided have been paid.
Dated the 14th day of November, 2023
Selma Carlberg by K. Randall
Treasurer, Lincoln County, Montana
STATE OF MONTANA
County of Lincoln
Filed on the 14th day of November, 2023 A.D., at 10:23 o'clock A.m.
Corrina Brown
County Clerk and Recorder
By: Nichelle Byrd
Deputy
Instrument Record No. 308309

CS 4986 AL