

- CERTIFIED CORNER RECORDATION -

Corner 0 Mile Post Sec. 4 T. 37 N., R. 34 W., P.M., MT Lincoln County
Set: Continued from Page 1 Page 2 of 2

From which, established new accessories (Montana accessories only):

A Subalpine Fir, 9 ins. in diam., bears N. 57° E., a distance of 24.3 ft., scribed MONTANA BT in a double blaze and M 0 (for Mile Zero) scribed in the snow blaze.

A stainless steel post, 36 ins. long, 2 1/2 ins. in diam., for a reference monument, bears S. 34°30' E., a distance of 11.64 ft., with two magnetic memorials set along the East & West sides of the post, 12 ins. below the ground surface; at the base of the post, set a bottle of Crown Royal whisky (with about 3 oz. remaining), also at the base, placed a plastic bottle of Dr. Pepper, containing: a penny, two nickels, a dime, a quarter, numerous business cards from crew members present, a page of "Rite-In-The-Rain" paper with all crew members names written on it, and a red plastic survey cap marked "Block 7918S"; the post has a 3 1/4 ins. diam. brass cap marked:

From which, new accessories:

A Western Red Cedar, 8 ins. in diam., bears S. 6° E., a distance of 29.8 ft., scribed MONTANA BT, in a single blaze, with a snow blaze above.

Refer to a Corner Perpetuation and Filing Record form recorded in Boundary County, Idaho, by Frank S. Wratni, R.L.S. 4343, for the Idaho Professional Land Surveyors Society, in unsurveyed Section 10, Township 65 North, Range 3 East, Boise Meridian.

A location poster was set North, 142.5 ft. distance. The International Boundary is North, 167 ft. distance from the granite monument.

Geographic Position: Lat. 49° 00' 01.6" North, Long. 116° 02' 52.9" West, NAD-27, ±5 meters, using a Trimble Pathfinder GPS receiver.

Painted bearing trees and attached Bearing Tree signs. Field work done on August 8, 1999.

Magnetic Declination: 20° East assumed. Equipment used: staff compass and Kesson tape.

Survey Crew: Bryan Block, 7918S; Daniel P. Brien, 7681S; Albert Dorsett; Dave Dorsett, 9006S; Michele Dorsett; Scott Dorsett; Rick Goacher, 7318S; Roger O. Green, 13769LS; Stephen Jeske, PLS7540*; John Marquette, PLS7877*; Valerie McKay; Steve Moyer, PLS6050*; Jerry Ott; Vicky Reynolds, 11379LI; Dick Smith, 4740S; Eli Smith; Linda S. Smith, 6296S; James R. (Dick) Staples, 9958S & PLS3628*; Greg Thurston, 10803S; Frank Wratni, PLS4343* and Robert K. Wunderlich, 13110LI.

* = Idaho Professional Land Surveyor

Kootenai National Forest, 1101 Highway 2 West, Libby, Montana 59923

(406) 293-6211

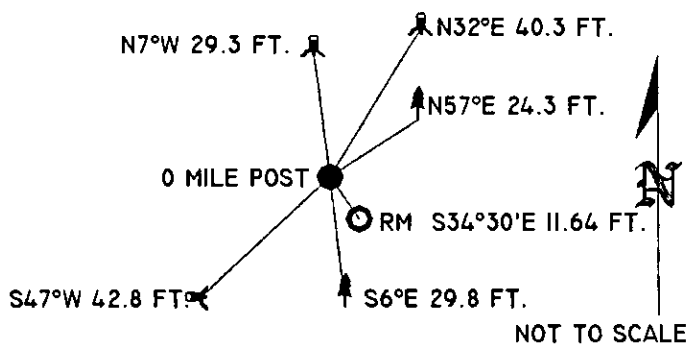

SKETCH OF CORNER

CERTIFICATION

I, _____, certify the information shown herein is true and correct.

I, Roger O. Green, certify that this Corner Record correctly represents work performed by me or under my direction in compliance with the "Corner Recordation Act" (70-22-401, et seq., M.C.A.).

Roger O. Green
Signature of Surveyor & Seal

Date: 1/20/2000

Reg. No.: 13769LS

Employer: U.S. FOREST SERVICE

Office of Clerk and Recorder, County of Lincoln. This "corner record" was filed for

record on 1-21-2000 and was noted on the cross-index plat and is assigned page No. 10408

in book No. _____

Coral M. Cunningham By RLB
County Official

Cross Index No.

R-17

T. 37 N., R. 34 W.

Adopted July 1, 1981, Montana Board of Professional Engineers & Land Surveyors

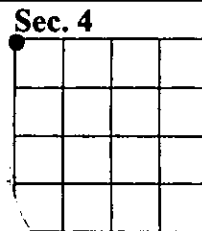

Corner this sheet
M., MT

R. 34
02

- CERTIFIED CORNER RECORDATION -

Corner 0 Mile Post Sec. 4 T. 37 N., R. 34 W., P.M., MT Lincoln County

Page 1 of 2

Record:

1899 Original Record by D. L. Reaburn, U. S. Surveyor, U. S. Geological Survey: As stated in "Field Notes of the Survey of the Boundary Line Between Idaho and Montana from the Crest of the Bitter Root Mountains, being the 39th Meridian West from Washington". "For filing in the Surveyor General's Office of Montana."

"At the point corresponding to the intersection of the International Boundary Line between the United States and Canada with the 39th meridian west (sic) from Washington." "Erected a granite monument 6 ft. long and 10 in. square, 3 ft. in the ground, and the faces directed to the cardinal points. The monument was originally cut into ten sections and is cemented together with Portland cement, each joint being strengthened by a copper bolt 1 in. in diameter and 4 in. long. In the top of the monument is cemented an aluminum tablet marked U.S. Geological Survey B. M., elev. 4500 ft., 1899. The monument is marked near the top in deeply cut characters in the following manner:

On the west face Idaho,
 " " north " Canada,
 " " east " Montana.

Underneath the monument is placed 4 quarts of charcoal and the earth about the base of the monument is firmly packed. The timber and brush are cut out for a radius of 40 feet from the monument. From the monument,"

- "A pine 15 in. diam., deeply engraved Canada B. T., bears N. 32°00' E., 40.3 ft. distant,"
- "A pine 12 in. diam., deeply engraved Mont. B. T., bears S. 58°00' E., 31.6 ft. distant."
- "A pine 15 in. diam., deeply engraved Idaho B. T., bears S. 47°30' W., 42.8 ft. distant."
- "A pine 15 in. diam., deeply engraved Canada B. T., bears N. 7°00' W., 29.3 ft. distant."

Found:

Found a granite monument, 10 inches square, with two sections above ground and the top two sections lying on the ground. Moss was removed from the monument revealing deeply cut characters on the sides ("Canada, Idaho, & Montana") and the marked aluminum tablet cemented in the top of the monument, which was marked:

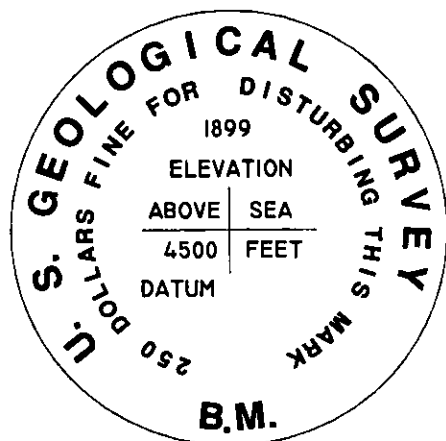

From which:

Decayed remains, size indeterminate, bears N. 32°00' E., 40.3 ft. distant, with a portion of the face alongside, deeply engraved "BT".

Decayed remains, size indeterminate, at record for the S.E. bearing tree.

A fallen pine, 15 ins. in diam., bears S. 47°30' W., 42.8 ft. distant, deeply engraved "IDAHO PO BT".

A pine snag, 15 ins. in diam., bears N. 7°00' W., 29.3 ft. distant, with a portion of the face lying alongside, deeply engraved "CANADA BT".

Set:

This is a joint project between the Idaho Professional Land Surveyors Society and the Montana Association of Registered Land Surveyors. 100 years after this monument was established, we returned to refurbish it and establish new accessories.

We re-cemented the upper sections of the monument to the base, which remained in place. All of the original markings of the monument are now clearly visible,

Continued on Page 2

Cross Index No. R-17 T. 37 N., R. 34 W.,

P.M., MT

10409

1 of 2