

CERTIFIED CORNER RECORDATION

Corner 1/4 Sec. 23 / 26 T. 37N R. 31W P.M., MT Lincoln County

- I. 1931 original G.L.O. record by Ranney Y. Lyman: Set an iron post, 3 ft. long, 1 in. diam., 28 ins. in the ground, with a brass cap mkd:

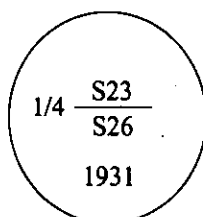

from which:

- A spruce, 14 ins. diam., bears North, 33 lks. dist., mkd. "1/4 S23 BT".
- A spruce, 8 ins. diam., bears S 8 3/4°W, 32 lks. dist., mkd. "1/4 S26 BT".

- II. Found an iron pipe, 1 in. diam, with a brass cap, 2 1/2 ins. diam, broken off and pulled out of the ground. Found the bottom of the pipe when digging the hole to place the new monument.

from which:

- A rotten spruce stump, bears North, 21.8 ft. (33 lks.) dist., with "1/4 S23 B" visible.
- A rotten, loose piece of spruce, laying south of the corner, with "BT" visible.
- A spruce, 14 ins. diam., bears S 7°W, 32.0 ft. (48 lks.) dist., mkd. "10' N TO BT S26". (No record)

- III. In the exact position of the found bottom portion of original corner, set a 30 in. long, 2 1/2 in. diam. alum. pipe, 22 ins. in the ground, with a 3 1/4 in. diam. alum. cap, mkd. as shown:

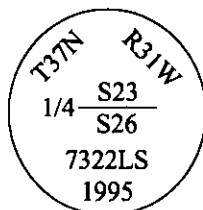

Established 1 new bearing tree:

- A spruce, 22 ins. diam., bears N 60°W, 51.9 ft. dist., mkd. "1/4 S23 BT".

Painted bearing trees and attached Land Survey Monument and Bearing Tree signs.
Magnetic Declination: 20° East.

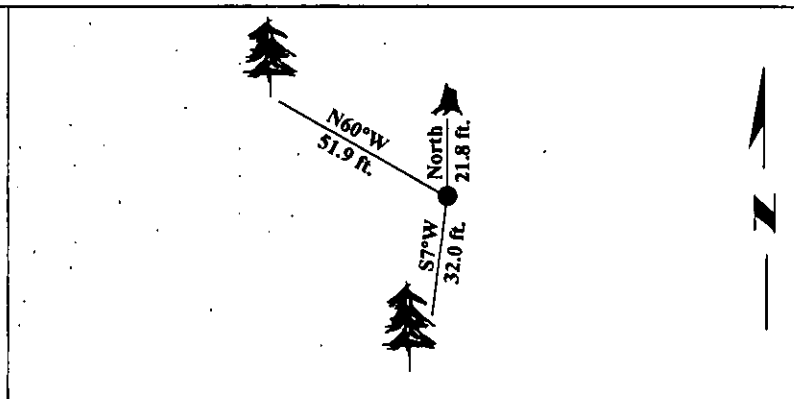

SKETCH OF CORNER

CERTIFICATION	
I. <u>Rex O. Rice</u>	certify the information shown herein is true and correct.
<u>Rex O. Rice</u>	
II. <u>Alvah F. Hughes</u>	certify that this Corner Record correctly represents work performed by me or under my direction in compliance with the "Corner Recordation Act" (70-22-101, et seq., M.C.A.)
<u>Alvah F. Hughes</u>	
Date: <u>2/1/96</u>	Signature of Surveyor & Seal
Reg. No.: <u>7322LS</u>	
Employer: <u>U.S. FOREST SERVICE</u>	

Office of Clerk and Recorder, County of LINCOLN. This "corner record" was filed for record on JUN 25, 1997 was noted on the cross-index plat and is assigned page No. 9690 in book No. CORAL M. CUMMINGS

County Official By PLB

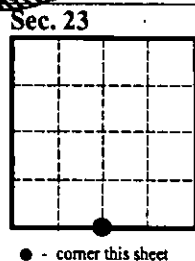

• - corner this sheet