

# CERTIFIED CORNER RECORDATION

Corner E 1/16 Sec. 26&35 T. 37 N R. 31 W P.M., MT Lincoln County

- I. No previous history.
- II. Found 1/2 in. diam. rebar. No record filed in Lincoln County Clerk and Recorder's office.
- III. At the position determined by survey, set a 30 in. long, 3/4 in. diam. alum. rod, 18 ins. in the ground, with a 3 1/4 in. diam. alum. cap mkd. as shown:

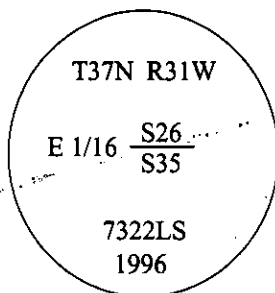

Established two bearing trees:

- A hemlock, 20 ins. diam., bears N40°E, 30.3 ft. dist., scribed "E 1/16 S26 BT".
- A hemlock, 12 ins. diam., bears S22°E, 31.3 ft. dist., scribed "E 1/16 S35 BT".

Painted bearing trees and attached Land Survey Monument and Bearing Tree signs.

A rebar, 1/2 in. diam., bears N69°W, 1.5 ft. dist. from monument.

Set 6 ft. steel guard post, East, 4 ft., with Land Survey Monument and Property Boundary decals.

Magnetic Declination: 20° East.

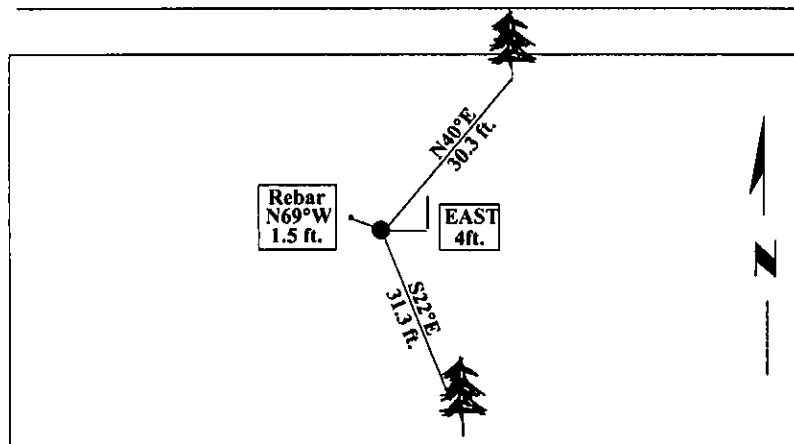

SKETCH OF CORNER

**CERTIFICATION**

I, Mark Federman  
certify the information shown herein is true and correct.

I, Alvah F. Hughes  
certify that this Corner Record correctly represents work performed by me or under my direction in compliance with the "Corner Recordation Act" (70-22-101, et seq., M.C.A.).

Alvah F. Hughes  
Signature of Surveyor & Seal

Date: 12/28/96

Reg. No.: 7322LS

Employer: U.S. FOREST SERVICE

**REGISTERED LAND SURVEYOR**

Office of Clerk and Recorder, County of LINCOLN. This "corner record" was filed for record on FEB 3, 1997 was noted on the cross-index plat and is assigned page No. 9164, in book No. \_\_\_\_\_

CORAL M. CUMMINGS  
 County Official

Sec. 26

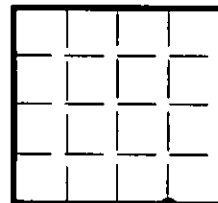

• - corner this sheet