

CERTIFIED CORNER RECORDATION

Corner 4 HES 833 Sec. 23 T. 37 N R. 31 W P.M., MT Lincoln County

- I. 1919 U.S. Forest Service original record by W. P. Stephenson: Set a small stone, marked with a cross (x), under an iron post, 2 ins. diam., 36 ins. long, 24 ins. in the ground with a brass cap marked 1919 4 H E S 833, and a point on top for the exact corner point, from which:

A cross (x) on a fir tree, 5 ins. diam., bears N38° 03'W, 19 lks. dist.

A cross (x) on a pine tree, 6 ins. diam., bears N 64° 42'E, 28 lks. dist., each blazed and scribed 4 H E S 833 BT.

Raised a mound of earth, 4 ft. base, 2 ft. high, NW of corner.

- II. Found a 2 1/2 in. diam. iron pipe, firmly set, 11 ins. above the ground, with a USFS brass cap mkd. as shown.

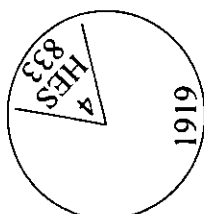

from which:

A down pine stump, 7 ins. diam., bears N 65°E, 18.5 ft. dist., mkd. with visible scribe marks.

A rotten fir stump, bears N 38°W, 12.3 ft. dist., mkd. with visible scribe marks.

- III. Established two new bearing trees:

A larch, 30 ins. diam., bears S 71°W, 41.0 ft. dist., mkd. 4 HES 833 BT.

A fir, 11 ins. diam., bears S 14°W, 47.3 ft. dist., mkd. 4 HES 833 BT.

Painted bearing trees and attached Land Survey Monument and Bearing Tree signs.

Magnetic Declination: 20° East.

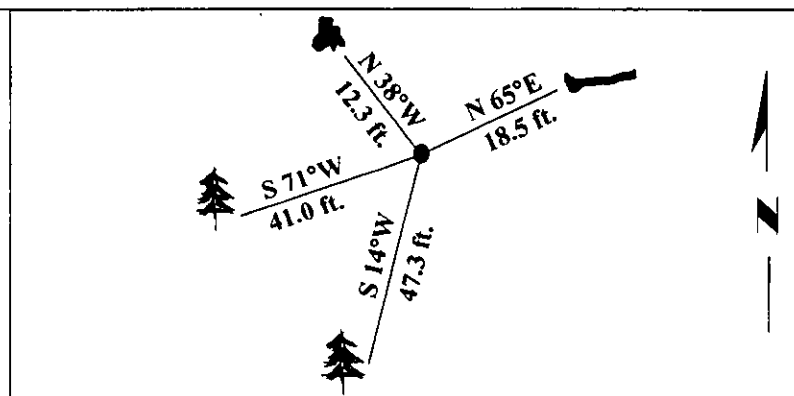

SKETCH OF CORNER

<p>CERTIFICATION</p> <p>i. <u>Mark A. Federman</u> <small>certify the information shown herein is true and correct.</small></p>	
<p>ii. <u>Ronald A. Pearson</u> <small>certify that this Corner Record correctly represents work performed by me or under my direction in compliance with the "Corner Recordation Act", 37-2-2401, et seq., M.C.A.)</small></p> <p><i>[Signature]</i> Signature of Surveyor & Seal</p>	
Date:	<u>4/8/96</u>
Reg. No.:	<u>9008LS</u>
Employer:	<u>U.S. FOREST SERVICE</u>

Office of Clerk and Recorder, County of Lincoln. This "corner record" was filed for record on Apr 30, 1996 was noted on the cross-index plat and is assigned page No. 9003 in book No. _____

[Signature]
 County Official

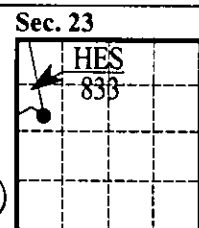

• - corner this sheet

Cross Index No. 4 HES 833 T. 37 N R. 31 W P.M., MT