

INSTRUCTIONS

1. Original and/or subsequent record used to evaluate the corner position.
2. Description of evidence found, note discrepancies in the record, state method of establishing lost or obliterated corners.
3. Description of monument and accessories set to perpetuate the corner position.
4. Sketch of corner, show all pertinent data which can best be shown in a sketch example, corner marking, topography ties, position of accessories, etc.
5. Certification must be signed and sealed by Land Surveyor registered in the State of Montana.
6. Fill in Cross Index & Section Diagram at bottom of sheet.

CERTIFIED CORNER RECORDATION

Corner 1 of HES 840 T. 37 N. R. 31 W. P.M.M. Lincoln County

- I. 1919, original record by W. P. Stephenson: "Beginning at Cor. No. 2 of HES No. 842, which is an iron post, firmly set, 2 ins. dia., 12 ins. above ground, with a brass cap marked 1919, 2 HES 842, as set by me July 7, 1919, identical in point with Cor. No. 1 of the listing survey....I adopt this corner for Cor. No. 1 of this survey, mark it 1 HES No. 840 and from the point on top which is the exact corner point,

A cross (x) on a pine tree, 10 ins. dia., bears $N49^{\circ}22'E$, 11 lks. dist. (New BT.).

A cross (x) on a spruce tree, 10 ins. dia., bears $N8^{\circ}19'E$, 32 lks. dist. (New BT.); each blazed and scribed 1 HES 840 BT.

Raise a mound of stone, 4 ft. base, 2 ft. high NE of corner."

- II. Found a 2 ins. dia. iron pipe, 19 ins. out of the ground, loose and leaning with a 2 1/2 ins. dia. U.S.D.A. Forest Service brass cap, marked as shown:

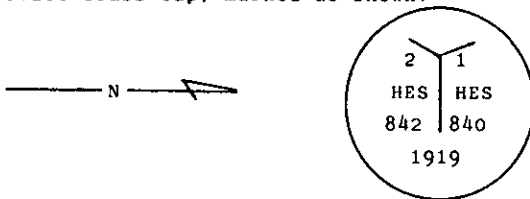

from which

A burnt stump, 9 ins. dia., 3 ft. high, bears $N48^{\circ}E$, 7.7 ft. (11.6 lks.) dist., mkd. HES 840 BT.

An iron pipe with brass cap for 1/4 cor. of secs. 10 and 15, bears $N74^{\circ}W$, 15.7 ft. dist.

Large mound of stone around iron pipe.

- III. Established two new accessories:

A larch, 14 ins. dia., bears $N4^{\circ}E$, 37.7 ft., mkd. 1 HES 840 BT.

A rock face, 80 ft. x 20 ft. high, bears $N80^{\circ}W$, 28.6 ft., mkd. X BO.

Straighten iron pipe to vertical position and rebuild supporting mound of stone.

Painted a red band around each bearing tree and attached Land Survey Monument and Bearing Tree signs.

Set a 6 ft. galvanized steel guard post with Property Boundary and Survey Marker decals attached, 4.2 ft. $N18^{\circ}W$.

Magnetic Declination: 20° East.

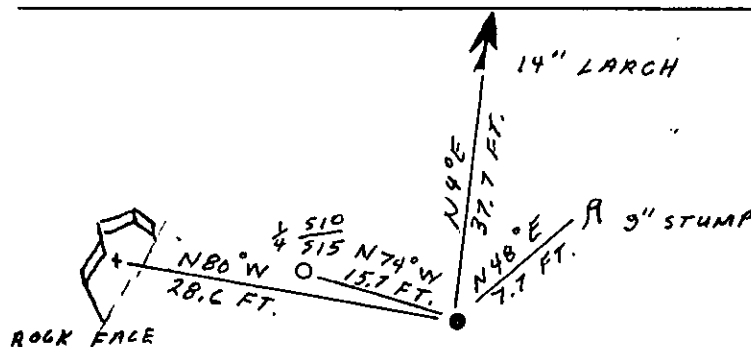

SKETCH OF CORNER

CERTIFICATION

I, Gary C. Crismon
certify the information shown herein is true and correct.

Gary C. Crismon
Signature Ground Party Chief

I, Alvah F. Hughes
certify that this Corner Record correctly represents work performed by me or under my direction in compliance with the "Corner Recordation Act" (70-22-101, et seq., M.C.A.)

Alvah F. Hughes
Signature of Surveyor & Seal

Date: 1/8/91 Reg. No. 7322

Employer: U.S. FOREST SERVICE

Office of Clerk and Recorder, County of Lincoln. This "corner record" was filed for record on 1-18-91

was noted on the cross-index plat and is assigned page No. 4514, in

book No. _____

Coral M. Cummings by Bill Brubaker
County Official

1 HES 840

37 N

31 W

Cross Index No. _____ T. _____ R. _____ P.M.M.

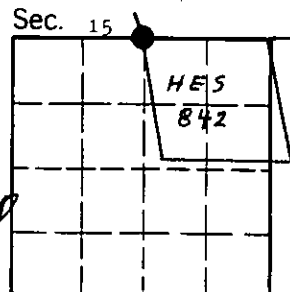

• - corner this sheet