

INSTRUCTIONS

1. Original and/or subsequent record used to evaluate the corner position.
2. Description of evidence found, note discrepancies in the record, state method of establishing lost or obliterated corners.
3. Description of monument and accessories set to perpetuate the corner position.
4. Sketch of corner, show all pertinent data which can best be shown in a sketch example, corner marking, topography ties, position of accessories, etc.
5. Certification must be signed and sealed by Land Surveyor registered in the State of Montana.
6. Fill in Cross Index & Section Diagram at bottom of sheet.

CERTIFIED CORNER RECORDATION

Corner 4 of HES 839 T. 37 N. R. 31 W. P.M.M. Lincoln County

- I. 1919, original record by W. P. Stephenson: "To a point on line 2 -3 of my previous survey of HES No. 840, which I establish for Cor. No. 4 of this survey as follows: Set a small stone marked with a cross (x), under an iron post, 2 ins. dia., 36 ins. long, 24 ins. in the ground, with a brass cap marked 1919, 4 HES 839, and a point on top for the exact corner point, from which

A cross (x) on a pine tree, 9 ins. dia., bears N84°35'W, 48 lks. dist.

A cross (x) on a pine tree, 9 ins. dia., bears N28°00'W, 31 lks. dist.

each blazed and scribed 4 HES 839 BT.

Raise a mound of earth and stone, 4 ft. base, 2 ft. high NW of corner."

- II. Found a 2 ins. dia. iron pipe, 13 ins. out of the ground, with a 2 1/2 ins. dia. U.S.D.A. Forest Service brass cap, marked as shown:

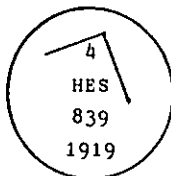
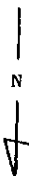

from which

No original bearing trees found, they fall in clear cut and old timber harvest area.

A mound of earth and stone, 2 ft. dia. by 1 ft. high, NW of corner.

- III. Established two new bearing trees:

A larch, 19 ins. dia., bears N13°E, 37.8 ft., mkd. 4 HES 839 BT.

A larch, 10 ins. dia., bears N56°E, 63.7 ft., mkd. 4 HES 839 BT.

Painted a red band around each bearing tree and attached Land Survey Monument and Bearing Tree signs.

Set a 6 ft. galvanized steel guard post with Property Boundary and Survey Marker decals attached, 3.8 Ft. North from corner.

Magnetic Declination: 20° East.

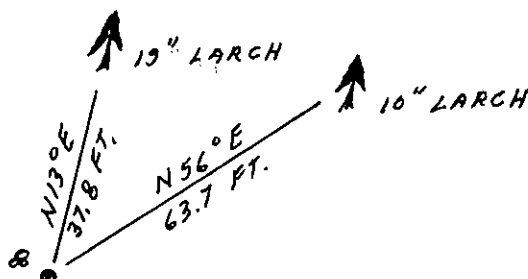

SKETCH OF CORNER

CERTIFICATION

- I. Gary C. Crismon
certify the information shown herein is true and correct.

Gary C. Crismon
Signature Ground Party Chief

- I. Alvah F. Hughes
certify that this Corner Record correctly represents work performed by me or under my direction in compliance with the "Corner Recordation Act" (70-22-101, et seq., M.C.A.)

Alvah F. Hughes
Signature of Surveyor & Seal

Date: 1/8/91 Reg. No. 7322 7322 L.S.

Employer: U.S. FOREST SERVICE

Office of Clerk and Recorder, County of Lincoln. This "corner record" was filed for record on 1-18-91

was noted on the cross-index plat and is assigned page No. 4512, in

book No. _____

Coral M Cummings by Bill Gault
County Official

4 HES 839 37 N 31 W

Cross Index No. _____ T. _____ R. _____ P.M.M.

Sec. 10

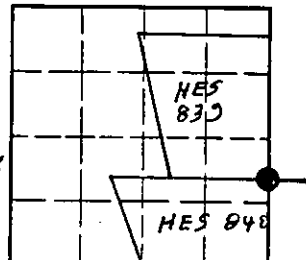

• - corner this sheet