

# CERTIFIED CORNER RECORDATION

Corner Sec. 15 South 1/16 T. 37 N R. 28 W P.M.M. Lincoln County  
 Corner Sec. 16 South 1/16 T. 37 N R. 28 W P.M.M. Lincoln County

ORIGINAL: None set.

SUBSEQUENT: COS 1849

PERPETUATION: Set 5/8" x 24" rebar, with plastic cap mkd.  
 "Breckenridge 11706LS"

Established a 7" fir BT bears S 49°10' W, 5.9 ft, scribed  
 "S 1/16 S16 BT"; Established a 10" fir, bears N 44°46' E, 26.4  
 feet, scribed "S 1/16 S15 BT".

See Certificate of Survey Number \_\_\_\_\_ for further  
 information.

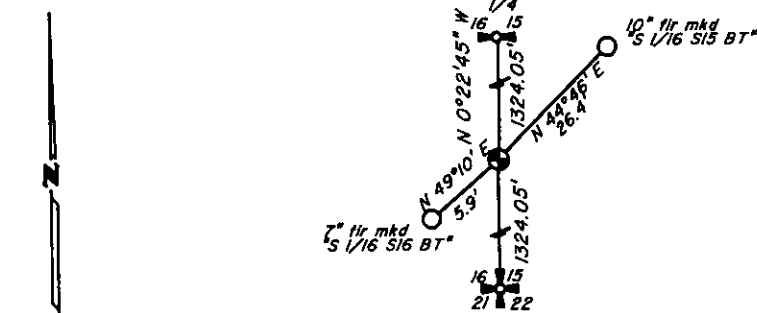

SKETCH OF CORNER

**CERTIFICATION**

I, Darren R. Breckenridge  
 certify the information herein is true and correct.

Darren R. Breckenridge  
 Signature Ground Party Chief

I, Darren R. Breckenridge  
 certify that this corner record represents work  
 performed by me or under my supervision in accordance with  
 the "Corner Recordation Act", M.C. 28-101, et seq. (M.C.)

Darren R. Breckenridge  
 Signature Registered Professional Engineer

Date: July, 1996  
 Employer: Breckenridge Land Surveying

Office of Clerk and Recorder, County of Lincoln. This "corner  
 record" was filed for record on July 10<sup>th</sup>, 1996  
 was noted on the cross-index plat and is assigned page No. 9009, in  
 book No. \_\_\_\_\_ Coral M. Cummings By OLB  
 County Official

Cross Index No. \_\_\_\_\_ T. 37 N R. 28 W PMM

Adopted July 1, 1981, Montana Board of Professional Engineers & Land Surveyors

Sec. 15

• corner this sheet