

- INSTRUCTIONS
1. Original and/or subsequent record used to evaluate the corner position.
 2. Description of evidence found, note discrepancies in the record, state method of establishing lost or obliterated corners.
 3. Description of monument and accessories set to perpetuate the corner position.
 4. Sketch of corner, show all pertinent data which can best be shown in a sketch example, corner marking, topography ties, position of accessories, etc.
 5. Certification must be signed and sealed by Land Surveyor registered in the State of Montana.
 6. Fill in Cross Index & Section Diagram at bottom of sheet.

CERTIFIED CORNER RECORDATION

Corner CW 1/16 S 9 BT Section 9 T. 37 N R. 28 W P.M.M. Lincoln County

I. 1991 Davis Surveying Inc.

I set a 5/8 inch dia. x 24 inch long rebar with Yellow PVC cap Stamped: KED 4975 S from which;

A Douglas fir, 7 inched D.B.H., bears N.75° E 25.3 feet from the center on the tree. Scribed CW 1/16 S 9 BT

A Douglas fir, 4 inched D.B.H., bears S.53° E 27.1 feet from the center of the tree. Scribed: with an "x" BT.

Painted a 6 inch wide red band around BT s with BT signs on front and warning signs #54.9 on back.

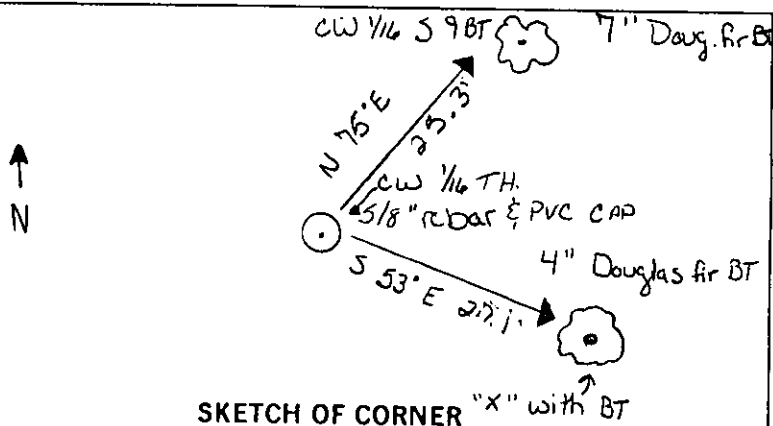

SKETCH OF CORNER "X" with BT

CERTIFICATION

I, Ken Davis

certify the information shown herein is true and correct.

John Damon, Brian Leisz, Bill Reichel

I, Ken Davis, certify that this Corner Record correctly represents work performed by me or under my direction in compliance with the "Corner Recordation Act" (70-22-01, et seq., M.C.A.).

Signature of Surveyor & Seal

Date: 8-5-91 REG. No. 4975 S

Employer: Davis Surveying, Inc.

Office of Clerk and Recorder, County of Lincoln. This "corner

record" was filed for record on Aug 23, 1991

was noted on the cross-index plat and is assigned page No. 4570, in

book No. _____

Coral M. Cummings by Bill Bechhoff
County Official

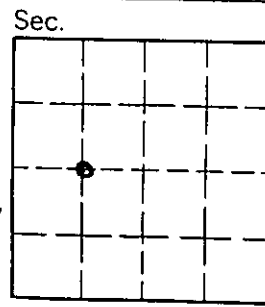

• corner this sheet