

INSTRUCTIONS

1. Original and/or subsequent record used to evaluate the corner position.
2. Description of evidence found, note discrepancies in the record, state method of establishing lost or obliterated corners.
3. Description of monument and accessories set to perpetuate the corner position.
4. Sketch or corner, show all pertinent data which can best be shown in a sketch example, corner marking, topography ties, position of accessories, etc.
5. Certification must be signed and sealed by Registered Land Surveyor in State of Montana.
6. Fill in Cross Index & Section Diagram at bottom of sheet.

CERTIFIED CORNER RECORDATION

Corner NW 1/16 SECTION 28 T. 37N R. 28W P.M.M. Lincoln County

(1) NO previous record or evidence

(2) Monument and accessories set to perpetuate corner position

Set standard 3/4 Forest Service alum. cap on 5/8 inch rod 18 inches into the ground, with rock mound, from which:
 A 9 inch fir bears N 71° E 18.60 feet scribed NW 1/16 S28 BT
 A 5 inch fir bears N 84° W 11.77 feet scribed NW 1/16 S28 BT
 Set a 6 foot steel post 3 feet north of corner.

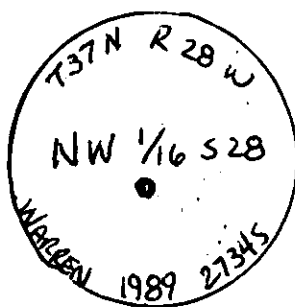

DECLINATION 19°

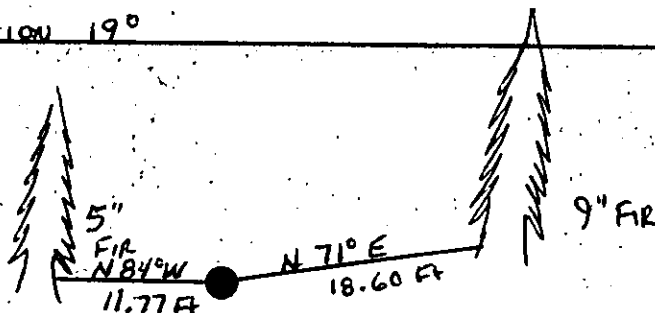

SKETCH OF CORNER

CERTIFICATION

I, DAN CROFT

certify the information shown herein is true and correct.

DAN CROFT
 Notary Public for Montana

I, WILLIAM E. WARDEN

certify that this corner record correctly represents work performed by me or under my direction in compliance with the "Corner Recordation Act," (70-2210, et seq., M.C.A.)

WILLIAM E. WARDEN
 Registered Land Surveyor & Seal

Date: 1989 27345

Employer: ROCKY MOUNT SURVEYORS

Office of Clerk and Recorder, County of Lincoln. This "corner record" was filed for record on the Dec 8, 1989 day of 19, was noted on the cross-index plat and is assigned page No. 4140, in book No. _____

Grant E. Sigel by Deed Sigel
 County Official

Sec. 28

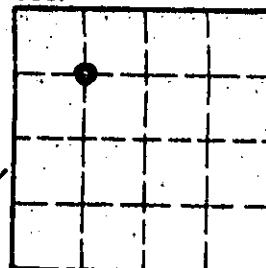

Cross Index No. S 10 T. 37N R. 28W P.M.M.

• corner this sheet