

INSTRUCTIONS

1. Original and subsequent record used to evaluate the corner position.
2. Description of evidence found, note discrepancies in the record, state method of establishing lost or obliterated corners.
3. Description of monument and accessories set to perpetuate the corner position.
4. Sketch or corner, show all pertinent data which can best be shown in a sketch example, corner marking, topography lies, position of accessories, etc.
5. Certification must be signed and sealed by Registered Land Surveyor in State of Montana.
6. Fill in Cross Index & Section Diagram at bottom of sheet.

CERTIFIED CORNER RECORDATION

Corner NW CORNER SEC. 4 T. 37N R. 28W P.M.M. Lincoln County

ORIGINAL SURVEY by F. SIZER and A. JAQUETH 1894

Set a sandstone 12x12x6 ins. 8 ins. into the ground with 4 notches on south and 2 notches on east edges; from which:

A 12 inch larch bears S 46 W 51 lks. mkd. T37N R28W S5 CC BT
(can not read size or kind in G.L.O. notes) bears S 25 45 E 54 lks. mkd. T37N R28W S4 CC BT

REMONUMENTATION by B.L.M. 1969

Found original stone lying loose on ground,
A stump bears S 25 45 E 54 lks. mkd. N R28W S4 CC BT
A 18 inch larch bears S 46 W 51 lks. mkd. 37 R28W S5 CC Bt

At the corner point, set a iron post 30 inches long 2½ ins. diam. 24 ins. into the ground, with brass cap.
From which;

A 6 inch fir bears S 53½ E 64 lks. mkd. T37N R28W S4 CC BT
A 4 inch fir bears S 61 W 55 lks. mkd. X BT
Buried original stone alongside.

FOUND

A 3½ inch brass cap set 24 ins. into the ground, from which:
A 10 inch fir bears S 54 E 42.34 feet scribe overgrown
A 8 inch fir bears S 59 W 36.18 feet scribe overgrown
A 24 inch larch snag bears S 44 W 34.72 feet scribe unreadable
A 14 inch stump bears S 25 E 36.00 feet with letters 28W

Maintained with required signs and paint, set a U.S.D.A. steel post 18 feet south.

DECLINATION 19°

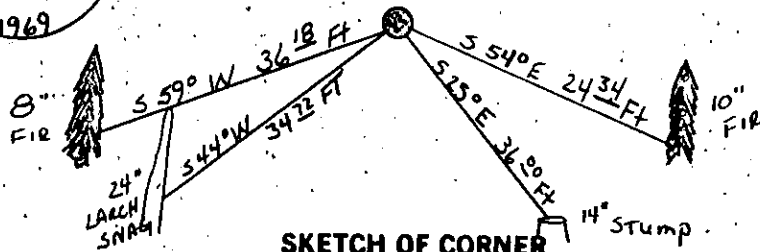
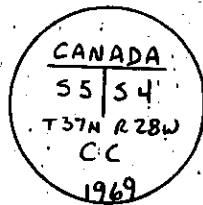

SKETCH OF CORNER

CERTIFICATION

DAN CROFT

certify the information shown herein is true and correct.

[Signature]
Registering Party Chief

1. GENE WARTEN
certify that this corner record correctly represents work performed by me or under my supervision in compliance with the "Corner Recordation Act," (70-22-101, et seq., M.C.A.)

[Signature]
Registered Land Surveyor & Seal

Date: 7-27-89 27345

Employer: ROCKY MOUNT SURVEYORS

Office of Clerk and Recorder, County of Lincoln This "corner record" was filed for record on the Sept 11, 1989 day of 19, was noted on the cross-index plat and is assigned page No. 4098 in book No. _____

County Official *[Signature]*

Cross Index No. A-09 37N 28W P.M.M.

Sec. 4

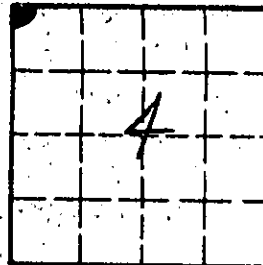

• corner this sheet