

INSTRUCTIONS

1. Original and/or subsequent record used to evaluate the corner position.
2. Description of evidence found, note discrepancies in the record, state method of establishing lost or obliterated corners.
3. Description of monument and accessories set to perpetuate the corner position.
4. Sketch or corner, show all pertinent data which can best be shown in a sketch example, corner marking, topography ties, position of accessories, etc.
5. Certification must be signed and sealed by Registered Land Surveyor in State of Montana.
6. Fill in Cross Index & Section Diagram at bottom of sheet.

CERTIFIED CORNER RECORDATION

Corner C.W.E. SE 1/256 T. 37n R. 28w P.M.M. Lincoln County

RECORD C.O.S. 1467

Set a 5/8 inch rebar with yellow plastic cap.

FOUND

A 1 inch yellow plastic cap on a 5/8 inch rebar set flush with the ground. No bearing trees were found.

New BTs:

A 8 inch pine bears N 30 W 21.05 feet scribed C W E SE 1/256

S11 BT

A 8 inch fir bears N 77 E 34.10 feet scribed C W E SE 1/256

S11 BT

Set a U.S.D.A. steel post 3 feet west:

D. K. MARQUARDT

2989 ES

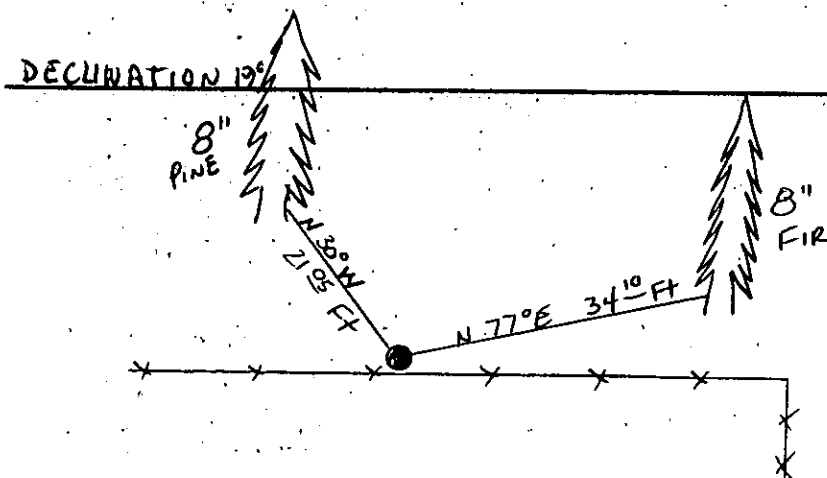

SKETCH OF CORNER

CERTIFICATION

I, DAN CROFT

certify the information shown herein is true and correct.

I, GENE WARTEN

certify that this corner record correctly represents work performed by me or under my direction in compliance with the "Corner Recordation Act" (70-22-101 et seq., M.C.A.)

Date: 7-25-89 1644R 2734S

Employer: ROCKY MOUNT SURVEYORS

Office of Clerk and Recorder, County of Lincoln This "corner record" was filed for record on the Sept 11, 1989 day of 19, was noted on the cross-index plat and is assigned page No. 4088, in book No. _____

Grant BT Suppl by Bill Duckhoff
County Official Dep.

Cross Index No. H-20 1/2 T. 37N R. 28W P.M.M.

Sec. 11

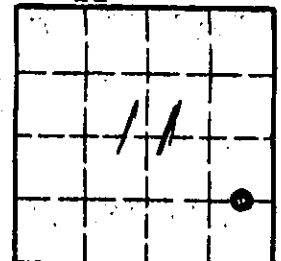

• corner this sheet