

INSTRUCTIONS

1. Original and/or subsequent record used to evaluate the corner position.
2. Description of evidence found, note discrepancies in the record, state method of establishing lost or obliterated corners.
3. Description of monument and accessories set to perpetuate the corner position.
4. Sketch or corner, show all pertinent data which can best be shown in a sketch example, corner marking, topography ties, position of accessories, etc.
5. Certification must be signed and sealed by Registered Land Surveyor in State of Montana.
6. Fill in Cross Index & Section Diagram at bottom of sheet.

CERTIFIED CORNER RECORDATION

Corner WEST ¼ SECTION 11 T. 37N R. 28W P.M.M. Lincoln County

ORIGINAL SURVEY by F. SIZER and A. JAQUETH 1894

Set a slatestone 14x10x4 ins. 10 ins into the ground for ¼ section corner marked ¼ on west face, from which:

A 18 inch fir bears S 36 E 48 lks. mkd. ¼ S BT

A 8 inch fir bears S ½ W 44 lks. mkd. ¼ S BT

REMONUMENTATION by B.L.M. 1968

Set a iron post 30 inches long 2½ ins. diam. 24 inches into the ground, with brass cap, from which:

The original BTs:

A 22 inch stump bears S 36 E 48 lks. mkd. BT (record)

A 16 inch stump bears S ½ W 44 lks. mkd. BT (record)

The new BTs:

A 5 inch pine bears S 83 E 16 lks. mkd. ¼ S11 BT

A 6 inch fir bears N 49 W 54 lks. mkd. ¼ S10 BT

Buried original along side iron post.

FOUND

A 3½ brass cap 8 inch out of ground, from which:

A 22 inch stump bears S 35 E 31.61 feet mkd. BT

A 16 inch stump bears S ½ E 29.50 feet mkd. BT

A 6 inch pine bears S 83 E 11.50 feet scribe overgrown

A 7 inch fir bears N 48 W 36.00 feet scribe overgrown

Maintained BTs with required signs and paint, also set a U.S.D.A. steel post 3 feet east.

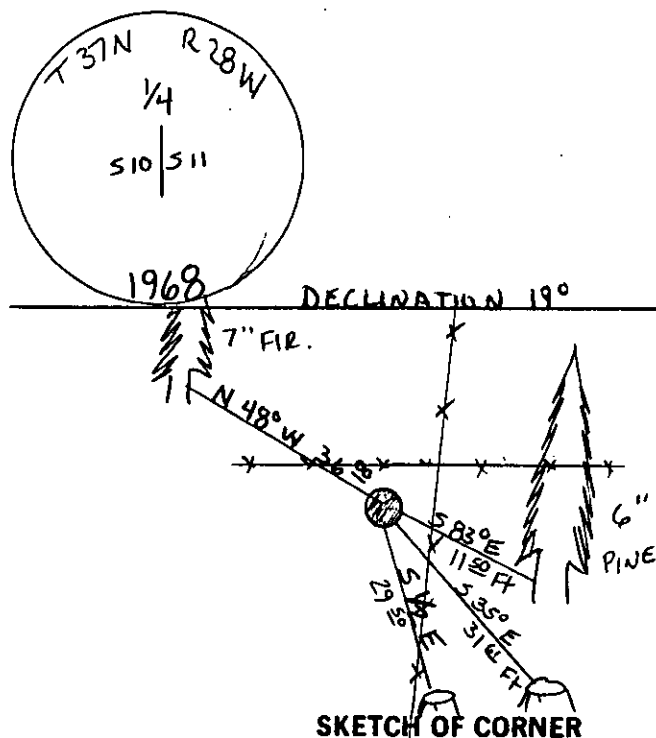

CERTIFICATION

DAN CROFT

I, DAN CROFT
certify the information shown herein is true and correct.

I, GENE WARREN
certify that this corner record correctly represents work performed by me or under my supervision in compliance with the "Corner Recordation Act" (70-22-101, et seq., M.D.A.).

Date: 7-28-1989

Employer: ROCKY MOUNT SURVEYORS

Office of Clerk and Recorder, County of Lincoln. This "corner record" was filed for record on the Sept 11, 1989 day of 19, was noted on the cross-index plat and is assigned page No. 4086, in book No.

Cross Index No. G-17 T. 37N R. 28W P.M.M.

Sec. 11

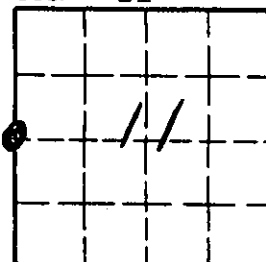

• corner this sheet