

INSTRUCTIONS

1. Original and/or subsequent record used to evaluate the corner position.
2. Description of evidence found, note discrepancies in the record, state method of establishing lost or obliterated corners.
3. Description of monument and accessories set to perpetuate the corner position.
4. Sketch or corner, show all pertinent data which can best be shown in a sketch example, corner marking, topography ties, position of accessories, etc.
5. Certification must be signed and sealed by Registered Land Surveyor in State of Montana.
6. Fill in Cross Index & Section Diagram at bottom of sheet.

CERTIFIED CORNER RECORDATION

Corner Boundary Monument 242 T. 37N R. 28W P.M.M. Lincoln County

RECORD

International Boundary Commission 1904
Latitude 48 59 58.83 Longitude 115 13 37.31 1927 N.A.D.

FOUND

Found a 4½ foot Obelisk 9x9 inches at the base, set in concrete and marked 242 on west face, and painted silver. No bearing trees were found.

New bearing trees:

A fir 7 ins. bears S 51 E 39.70 feet scribed T37N R28W MON 242
BT

A fir 8 ins. bears S 20 W 21.50 feet scribed T37N R28W MON 242
BT

Bearing trees had 6 inch bands and there scribe painted red, along with the required signs attached, a U.S.D.A. steel post was set South 19.57 feet from the corner.

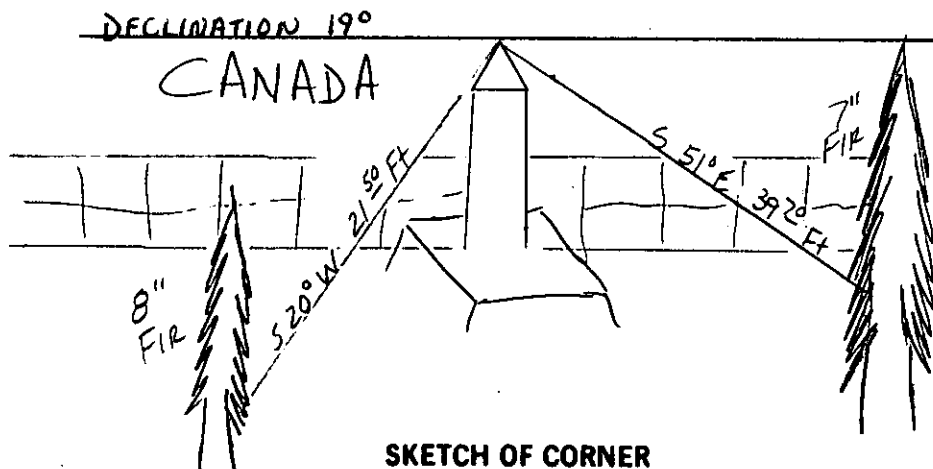

SKETCH OF CORNER

CERTIFICATION

I, Dan Croft

certify the information shown herein is true and correct.

Dan Croft
Signature of Registered Land Surveyor

I, GENE WARTEN
certify that this corner record correctly represents work performed by me or under my direction in compliance with the "Corner Recordation Act" (70-22-101, et seq., M.C.A.)

2734 S
Signature of Registered Land Surveyor

Date: 7-28-89 1989

Employer: ROCKY MOUNTAIN SURVEYORS

Office of Clerk and Recorder, County of Lincoln. This "corner record" was filed for record on the Sept 11, 1989 day of 19, was noted on the cross-index plat and is assigned page No. 4078, in book No. _____

Cross Index No. A-15 T. 37N R. 28W P.M.M.

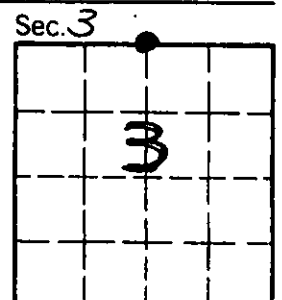

• corner this sheet