

## INSTRUCTIONS

1. Original and/or subsequent record used to evaluate the corner position.
2. Description of evidence found, note discrepancies in the record, state method of establishing lost or obliterated corners.
3. Description of monument and accessories set to perpetuate the corner position.
4. Sketch of corner, show all pertinent data which can best be shown in a sketch example, corner marking, topography ties, position of accessories, etc.
5. Certification must be signed and sealed by Land Surveyor registered in the State of Montana.
6. Fill in Cross Index & Section Diagram at bottom of sheet.

## CERTIFIED CORNER RECORDATION

Corner of Secs. 28, 29, 32, 33 T. 37 N., R. 28 W., P.M.M. Lincoln County

- I. 1894, original, G.L.O., record by P. Sizer & A. Jaqueth: "Set a limestone 14x10x5 ins., 10 ins. in the ground for cor. to secs. 28, 29, 32, & 33 marked with 1 notch on S. and 4 notches on E. edges ....", marked four bearing trees as accessories.
- 1930 resurvey by R. Lyman: The corner of secs. 28, 29, 32, and 33, which is a slate stone, 10x10x8 ins. above ground, marked and witnessed as described in the official record, except that the northwest bearing tree bears N72° 0' W, instead of N27° 0' W.
- 1969, B.L.M., remonumentation by R. Leedy: The cor. of secs. 28, 29, 32 and 33, monumented with a limestone, 14x10x6 firmly set, mkd. 4 notches on the E., 1 notch on the S. edges, and witnessed by the remains of the original bearing trees:
- A larch snag, 12 ins. diam., bears N36 1/2° E, 42 lks. dist., mkd. T37N R28W S28 BT.
  - A fir, 12 ins. diam., bears S32 3/4° E, 40 lks. dist., mkd. T37N R28W S33 BT.
  - A fir, 9 ins. diam., bears S24° W, 16 lks. dist., mkd. T37N R28W S32 BT.
  - A stump hole, bears N72 1/4° W, 26 lks. dist., with fallen log lying alongside and on its face.
- At the corner point: set an iron post, 30 ins. long, 2 1/2 ins. diam., 24 ins in the ground, with brass cap mkd:

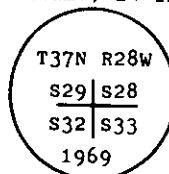

from which:

- A fir, 7 ins. diam., bears N27° E, 54 lks. dist., mkd. T37N R28W S28 BT.
- A larch, 9 ins. diam., bears N39° W, 43 lks. dist., mkd. T37N R28W S29 BT.

Bury the original stone alongside and raise a collar of stone, 2 ft. diam., around the iron post.

- II. Found a 3 1/4 ins. diam., B.L.M., brass cap, mkd. as shown above, on a 2 1/2 ins. diam. iron pipe, 8 ins. out of the ground with a small collar of stone, from which:
- A douglas fir, 11 ins. diam., bears N30° E, 35.9 ft. (54.4 lks.) dist., scribe overgrown.
  - A root crown, bears N36° E, 28 ft. (42.4 lks.) dist., scribe on log portion.
  - A douglas fir, 11 ins. diam., bears S32° E, 25.9 ft. (39.2 lks.) dist., scribe visible.
  - A douglas fir, 10 ins. diam., bears S26° W, 10.7 ft. (16.2 lks.) dist., scribe visible.
  - A larch, 10 ins. diam., bears N37° W, 27.9 ft. (42.3 lks.) dist., scribe visible.
  - Stump hole & rotten log, bears N72° W, 17.0 ft. (25.8 lks.) dist., no visible scribe.

- III. Set galvanized steel post with Land Survey Monument decal, bears North, 2 ft. dist. Sprayed red paint on scribe blazes and 6 in. band around all standing bearing trees. Posted Bearing Tree signs on front and Land Survey Monument signs on back of bearing trees.

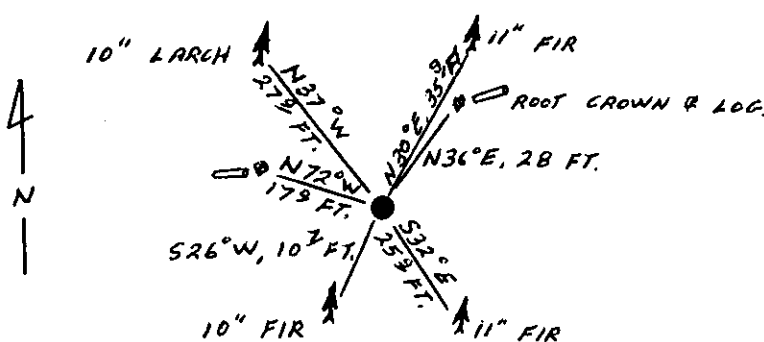

SKETCH OF CORNER

CERTIFICATION

Gary C. Crismon

I, Gary C. Crismon, certify the information shown herein is true and correct.

Linda S. Smith Signature of Second Party Chief

Linda S. Smith 6296 S

I, Linda S. Smith, certify that this Corner Record correctly represents work performed by me or under my direction in compliance with the "Corner Recordation Act", 170-2-101, et seq., M.C.A.

Linda S. Smith Signature of Land Surveyor & Seal

1/27/88 Date: 6296 Reg. No.

U.S. FOREST SERVICE

Employer:

Office of Clerk and Recorder, County of Lincoln. This "corner record" was filed for record on Feb 10, 1988 was noted on the cross-index plat and is assigned page No. 3830, in book No. \_\_\_\_\_

Gary C. Crismon County Official

V-9 Cross Index No. T. 37 N. R. 28 W. PMM

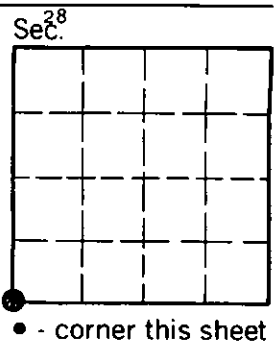

# INSTRUCTIONS TO SURVEYORS FOR COMPLETION OF CERTIFIED CORNER RECORDATION FORMS

## I. ORIGINAL AND/OR SUBSEQUENT RECORD:

This item should describe or quote those portions of the original or subsequent record which were used in evaluating the corner position. The original record will usually be the General Land Office field notes. Subsequent record can come from several sources: Previously filed corner records, maps and plats, private and public records, etc. Some of the subsequent record, even though not in the public record, but known to have validity by the surveyor, may be quoted and appropriately noted.

The record data helps support the reestablished corner position because it clearly shows what history the surveyor based his corner position on. In some cases, however, the record may be unknown or not pertinent. A statement to that effect should appear on the corner record.

## II. DESCRIPTION OF EVIDENCE FOUND OR METHOD OF LOCATING CORNER POSITION:

This item will describe the original or subsequent record evidence found. If portions of the found evidence cannot be reconciled with the record, then the disregarded record should be noted, and, if possible, an opinion as to its cause narrated.

If no physical evidence of the original or subsequent monuments and accessories can be found, then the method used to reestablish the lost or obliterated corner (single proportion, fence intersection, parol evidence, terrain calls, centerline of road, etc.) shall be indicated.

## III. DESCRIPTION OF MONUMENTS AND ACCESSORIES SET TO PERPETUATE THE CORNER POSITION:

This item should list all details about the corner and its location which will help exclusively identify the corner position; including size and type of monument, how marked if not shown in sketch, and distinguishing topographic calls which help locate the corner. In many cases, instructions on how to find the corner should be included.

References or ties to other corners are optional and may be drawn on the face or back of the corner record form, or references to Certificate of Survey may be made. Separate drawings may be attached to the corner form.

If state plane coordinate values for the corner position are shown, then the control upon which they are based should be indicated.

## IV. SKETCH OF CORNER:

This item will usually show how a found or set corner is marked and may also show topography or accessory monuments found or set and their relation to the corner. There is no stipulated format; the sketch could be transcribed field note entries.

## V. CERTIFICATION:

The name and signature of the ground party chief is optional.

The Surveyor who performed or directed the field work which is depicted on the "Certified Corner Record" shall sign and affix his seal in the Certification.

The employer blank is optional but useful in tracking down original field note data or adjacent record if, in the future, questions arise about the corner.

## VI.

The Cross Index at the bottom of the page should be completed by the Surveyor. Only the single Township Index where the corner is filed shall be completed.

The lower righthand corner is a corner location diagram and should have the pertinent section filled in at the top and a closed circle indicating the appropriate corner position in the section filled in. This is intended to be an aid in searching the "Record" once it has been filed.