

INSTRUCTIONS

1. Original and/or subsequent record used to evaluate the corner position.
2. Description of evidence found, note discrepancies in the record, state method of establishing lost or obliterated corners.
3. Description of monument and accessories set to perpetuate the corner position.
4. Sketch or corner, show all pertinent data which can best be shown in a sketch example, corner marking, topography ties, position of accessories, etc.
5. Certification must be signed and sealed by Registered Land Surveyor in State of Montana.
6. Fill in Cross Index & Section Diagram at bottom of sheet.

CERTIFIED CORNER RECORDATION

Corner S. 1/4 Sec. 35 (only) T. 37N. R. 28W. P.M.M. Lincoln County

I. From original 1894 G.L.O. notes; Set Limestone 16"x8"x6", 11" in ground mkd.

SC1/4 on North Face, from which:

A 26" Yellow Pine bears N.24°45'E., 33 lks., mkd. SC1/4S B.T.

A 22" Yellow Pine bears S.67°15'E., 30 lks., mkd. SC1/4S B.T.

II. Found COE 2 1/2" Brass Cap on Iron Pipe.

Found 30" Yellow Pine bears N.24°45'E., 21.8 ft., mkd. SC1/4S B.T.

Found 22" Yellow Pine Snag bears S.67°15'E., 19.8 ft., mkd. SC1/4S B.T.

III. Formed new rock cairn around mon. painted red.

Set 54-3 tag on 7 1/2" Tamarack bears S.44°W., 37.58 ft., mkd. SC1/4S35 B.T.

Also attached 54-4 tag.

Set 54-5 tag on corner post of cow enclosure bears S42°E., 9.7 ft.

I-A. C.O.E. re-mon, 1969; Set I.P. w/Brass cap.

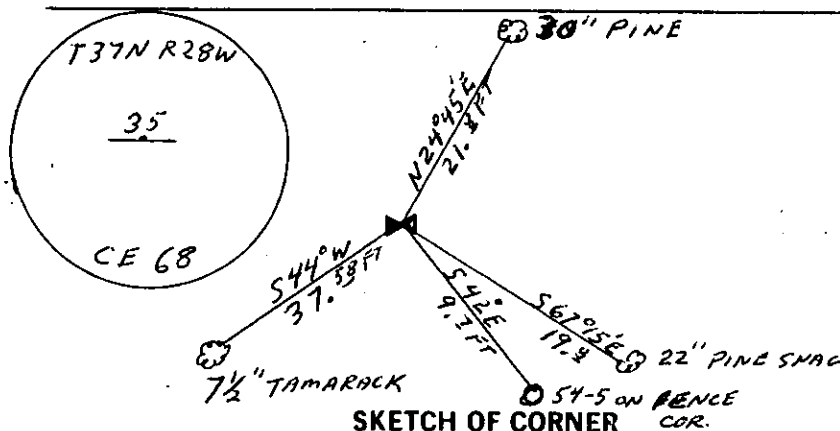

CERTIFICATION

I, F. D. Higgins

certify the information shown herein is true and correct.

F. D. Higgins

Signature Ground Party Chief

I, Carl R. McMullen, L.S.

certify that this Corner Record correctly represents work performed by me or under my direction in compliance with the "Corner Recordation Act" (70-101, et seq., M.D.A.)

Carl R. McMullen

Signature of Surveyor & Seal

Date: 12/12/83 Reg. No. 4659-S

Employer: Carl R. McMullen & Assoc.

Office of Clerk and Recorder, County of Lincoln. This "corner record" was filed for record on the March 21st day of 1984 was noted on the cross-index plat and is assigned page No. 2592, in book No. _____

Janet BF Siegel by Betty L. Conner
County Official deputy

Cross Index No. Z-19 T. 37N. R. 28W. P.M.M.

Sec. 35

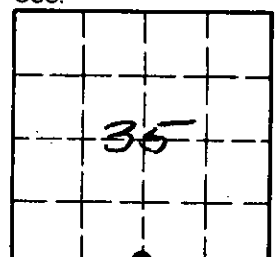

• - corner this sheet