

INSTRUCTIONS

1. Original and/or subsequent record used to evaluate the corner position.
2. Description of evidence found, note discrepancies in the record, state method of establishing lost or obliterated corners.
3. Description of monument and accessories set to perpetuate the corner position.
4. Sketch or corner, show all pertinent data which can best be shown in a sketch example, corner marking, topography ties, position of accessories, etc.
5. Certification must be signed and sealed by Registered Land Surveyor in State of Montana.
6. Fill in Cross Index & Section Diagram at bottom of sheet.

CERTIFIED CORNER RECORDATION

Corner E. 1/4 Cor. Sec. 34 T. 37N. R. 28W. P.M.M. Lincoln County

- I. From original 1894 G.L.O. notes: Set a Sand Stone 12"X8"X6", 8" in ground, mkd. 1/4 on West Face, from which:
 A Tamarack 12" in diam. bears N.21°45'W., 59 lks.
 A Tamarack 14" in diam. bears S.10°30'E., 54 lks.
- II. Found Stump of Orig. 12" Tamarack bears N.21°45'W., 38.94 ft., scribing visible.
 Found Stump hole bears S.10°30'E., 35.64 ft.
- III. Set U.S.D.A. Alum.Mon. 3" cap, in ground with Rock Cairn around it.
 Set 2 New B.T.s:
 A 8" Pine bears S.39°E., 30.3 ft., mkd. 1/4 S35 B.T.
 A 9" Tamarack bears S.56°W., 26.8 ft., mkd. 1/4 S34 B.T.
 Set 54-5 tag 95 ft. East of Cor.

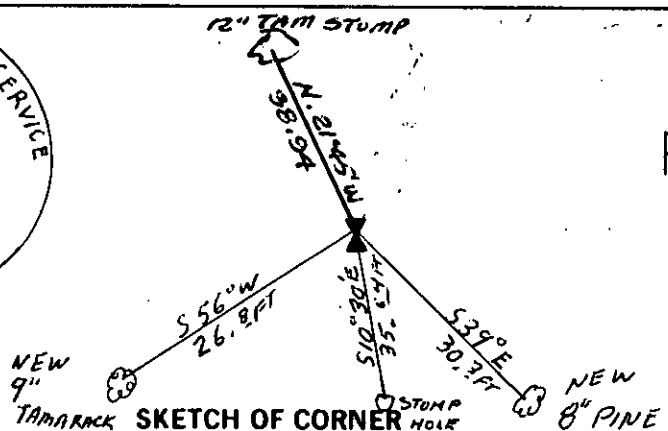
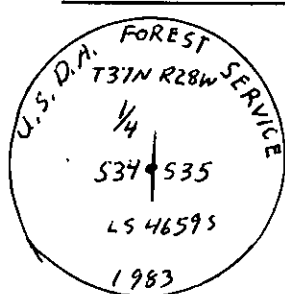
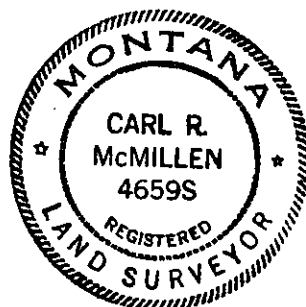

CERTIFICATION

I, F. D. Higgins
 certify the information shown herein is true and correct.

F. D. Higgins
 Signature Ground Party Chief

I, Carl R. McMullen, L.S.
 certify that this Corner Record correctly represents work performed by me or under my direction in compliance with the "Corner Recordation Act" (70-22101, as amended, M.D.A.)

Carl R. McMullen
 Signature of Surveyor & Seal

Date: 12/12/83 Reg. No. 4659-S

Employer: Carl R. McMullen & Assoc.

Office of Clerk and Recorder, County of Lincoln. This "corner record" was filed for record on the March 21st day of 1984 was noted on the cross-index plat and is assigned page No. 2586, in book No. _____

Janet BF Siegel by Betty L. Conner
 County Official deputy

Cross Index No. X-17 T. 37N R. 28W P.M.M.

Sec. 34

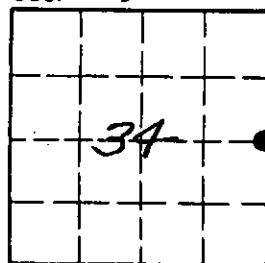

• corner this sheet