

INSTRUCTIONS

1. Original and/or subsequent record used to evaluate the corner position.
2. Description of evidence found, note discrepancies in the record, state method of establishing lost or obliterated corners.
3. Description of monument and accessories set to perpetuate the corner position.
4. Sketch of corner, show all pertinent data which can best be shown in a sketch example, corner marking, topography ties, position of accessories, etc.
5. Certification must be signed and sealed by Registered Land Surveyor in State of Montana.
6. Fill in Cross Index & Section Diagram at bottom of sheet.

CERTIFIED CORNER RECORDATION

Corner S. E. Cor. Sec. 14 T. 37N. R. 28W. P.M.M. Lincoln County

I. From original 1894 G.L.Q. notes: Set a Granite Stone, 14"x10"x5", 10" in ground with 3 notches on S. and 1 notch on E. edges, from which:

A 8" Fir bears N.54°E., 155 lks.

A 18" Yellow Pine bears S.50 1/4°E., 53 lks.

A 14" Fir bears S.61 1/4°W., 48 lks.

A 12" Fir bears N.5 1/2°W., 163 lks.

(SEE NOTE I-A)

II. Found C.O.E. R.M. Cap on ground along side iron pipe (did not use Mon.).

Found 8" Fir Stump bears N.54°E., 102.3 ft, visible scribe on tree along side.

Found Stump hole of 18" Pine, bears S.50 1/4°E., 35 ft.

Found Root wad of 14" Fir bears S.61 1/4°W., 31.7 ft.

Found 15" Fir bears N.64°W., 35 ft., mkd. FS/RM.

III. Set Driveable Alum. Mon. 6" below surface of paved road, (5/8"x24" Alum. Mon. w/3P cap).
Set New B.T.s:

A 7" Fir bears N.63°E., 20.60 ft., scribed T37N R28W S13 B.T.

A 14" Fir bears S.46°W., 84.70 ft., scribed T37N R28W S23 B.T.

Attached 54-3 tag to 6 1/2" post, 3' high, bears S.6°E., 63.45 ft., no scribe.

No tree in S.E. Quad.

I-A. C.O.E. re-mon., 1969: Set I.P. w/Brass cap 60.00 feet West of Corner for RM.
S.14 B.T., 15" Fir, bears N.64°W., 35.0 ft., mkd.- FS/RM.

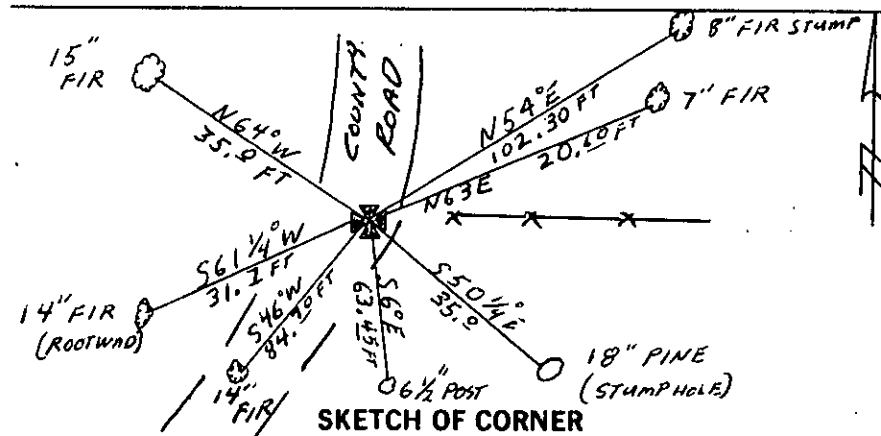

CERTIFICATION

I, F. D. Higgins

certify the information shown herein is true and correct.

F. D. Higgins

Signature Ground Party Chief

I, Carl R. McMullen, L.S.

certify that this Corner Record correctly represents work performed by me or under my direction in compliance with the "Corner Recordation Act" (70-22-101 to 104, M.C.A.)

Carl R. McMullen

Signature of Surveyor & Seal

Date: 12/12/83 Reg. No. 4659-S

Employer: Carl R. McMullen & Assoc.

Office of Clerk and Recorder, County of Lincoln. This "corner record" was filed for record on the March 21st day of 1984 was noted on the cross-index plat and is assigned page No. 2568, in book No. _____

Janet BF Siegel by Betty L. Conner
County Official deputy

Cross Index No. N-21 T. 37N R. 28W P.M.M.

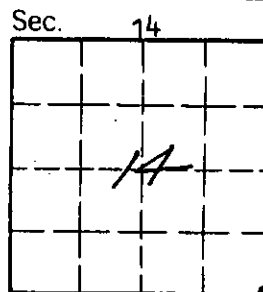

• - corner this sheet