

CERTIFIED CORNER RECORDATION

Corner COE 5700-1, SEC. 1 T. 37N R. 28W P.M.M. Lincoln County

1. NONE
2. Found:
A 3½ ins. Brass Cap in 4 ins. concrete stamped as shown.
3. Established:
A 6 ins. Douglas Fir S46°E, 25.40 ft. dist., scribed " 5700/1 BT "
An 8 ins. Ponderosa Pine bears S16°W, 17.9 ft., scribed " 5700/1 BT "
A Steel post with LSM and PB decals 2 ft. on line.
Painted red bands around the bearing trees and attached Land Survey Monument and Bearing Tree signs.

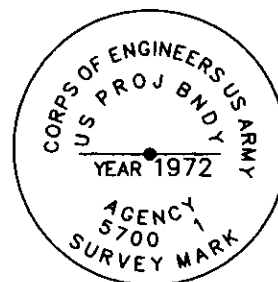

MAGNETIC DECLINATION - 16° EAST

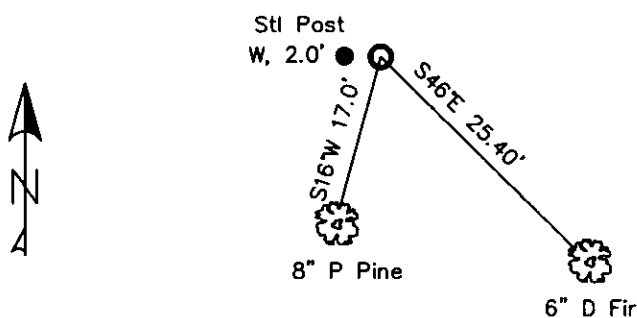

CERTIFICATION

I, ERICH SCHRACK
certify the information shown herein to be true and correct.

I, LAWRENCE A. GLAHE
certify that this Corner Recordation represents work performed by me or under my direction in compliance with the "Corner Recordation Act" (MCA 2-101, et seq., M.C.A.)

Date: 1-25-10 No. 9748 LS
Employer: GLAHE & ASSOCIATES, INC.

SKETCH OF CORNER

Office of Clerk and Recorder, County of Lincoln. This "corner record" was filed for record 224105 BOOK: CCR CC&R'S PAGE: 11357 Pages: 1
was noted on the cross-index STATE OF MONTANA LINCOLN COUNTY
book No. RECORDED: 01/27/2010 12:27 KOI: CC&R'S
TAMMY D. LAUER CLERK AND RECORDER
FEE: \$0.00 BY: Laurie Lauer Deputy
TO: FILED

Cross Index No. A-21/A-22 T. 37N R. 28W PMM

Adopted July 1, 1981, Montana Board of Professional Engineers & Land Surveyors

Sec. 1

●			

● corner this sheet