

CERTIFIED CORNER RECORDATION

Corner N 1/16 Secs. 35 & 36 T. 37N R. 28W P.M., MT Lincoln County

- I. 1983 Certified Corner Recordation by Carl R. McMillen, LS 4659S: This corner was not previously set. Set a Driveable Aluminum Monument with rock cairn, (5/8" x 24" Alum. Mon. w/3" cap).

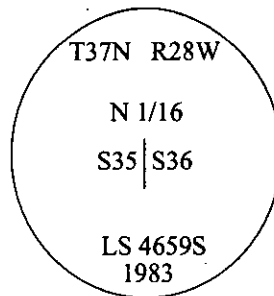

Scribed 2 trees:

- A 7" Red Fir, bears N12°E, 16.60 ft., marked. "N1/16 S36 BT".
A 8" Red Fir, bears S58°E, 52.60 ft. dist., mkd. "N1/16 S36 BT".

- II. Found a 5/8 in. diam. aluminum rod, protruding 2 ins. above the ground, firmly set, with a 3 in. diam. aluminum cap, mkd. as shown.

from which:

- A fir, 8 ins. diam., bears N12°E, 16.6 ft. dist., with visible scribe.
A fir snag, 9 ins. diam., bears S58°E, 52.6 ft. dist., with a healed face.

- III. Established one new bearing tree:

- A fir, 11 ins. diam., bearing N62°E, 50.4 ft. dist., mkd. "X" on snowblaze "BT".

Painted red bands around the bearing tree and attached Land Survey Monument and Bearing Tree signs.

Magnetic Declination: 20° East.

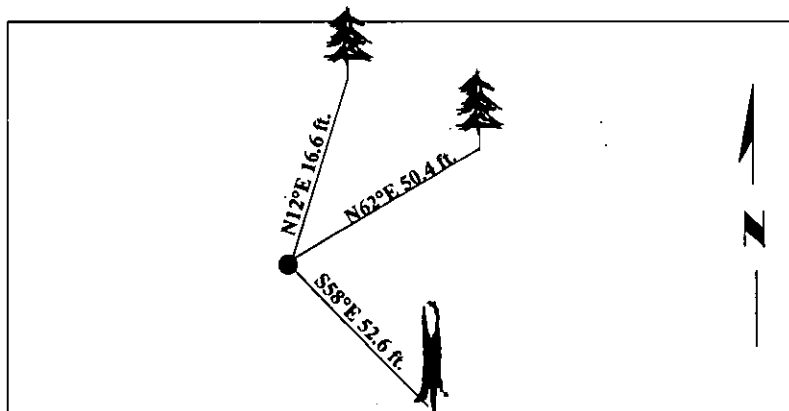

SKETCH OF CORNER

CERTIFICATION

- I. Rex O. Rice
certify the information shown herein is true and correct.

Rex O. Rice

- II. Steven A. Boyer
certify that this Corner Record correctly represents work performed by me or under my direction in compliance with the "Corner Recordation Act" (70-22-101 set sec. 1, M.C.A.)

Steven A. Boyer
Signature of Surveyor & Seal

Date: 6/10/98

Reg. No.: 9750LS

Employer: U.S. FOREST SERVICE

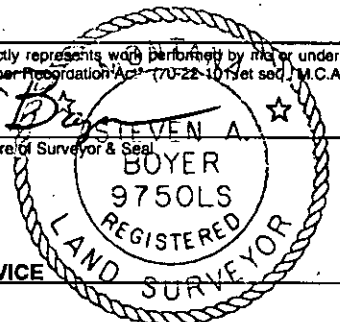

Office of Clerk and Recorder, County of Lincoln. This "corner record" was filed for record on Mar 3, 1999 was noted on the cross-index plat and is assigned page No. 10303 in book No. _____

Coral M. Cunningham By RLB
County Official

Sec. 36

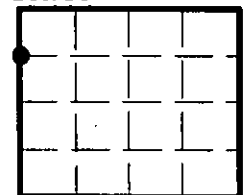

• - corner this sheet

Cross Index No. W-21 T. 37N R. 28W P.M., MT

Adopted July 1, 1981, Montana Board of Professional Engineers & Land Surveyors