

CERTIFIED CORNER RECORDATION

Corner S 1/4 Sec. 31 T. 37N R. 27W P.M., MT Lincoln County

- I. 1893 G.L.O. Original Record by Peter McCardell et. al.: Set a post, 3 ft. long, 3 ins. square, 24 ins. in the ground, for 1/4 sec. cor. mkd. "SC 1/4 S" on N. face. Established two bearing trees.
- 1969 Certified Corner Recordation by Lawrence A. Signani Registration No. 11422: Found one original bearing tree, which is a rotten stump, bearing S.W., with "BT" visible. Set a standard brass cap, at a bearing of N26°30'E, 10 lks. dist., from the recovered BT stump, with the brass cap mkd. as shown.

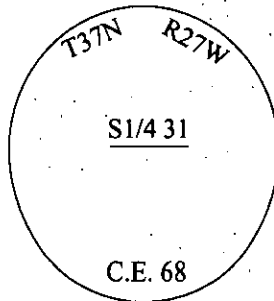

- II. Found a 2 1/2 in. diam. brass cap, firmly set, protruding 2 ins. above the ground, mkd. as shown above.

from which:

- A stump hole, bears N60°W, 27.0 ft. dist., with visible scribe. (G.L.O.-record-33.0 ft.)
- A stump hole, bears S26°W, 6.6 ft. dist. (G.L.O.-record)
- A pine, 22 ins. diam., bears N43°E, 55.2 ft. dist., mkd. "FS/RM". (1969-record)

- III. Established one new bearing tree and one steel post:
- A fir, 12 ins. diam., bears N11°W, 52.1 ft. dist., mkd. "1/4 S31 BT".
 - A 6 ft. post, West, on property line, 1.0 ft. dist. from the corner.

Painted bearing trees and attached Land Survey Monument and Bearing Tree signs.
Attached a Land Survey Monument decal to the post.

Magnetic Declination: 20° East.

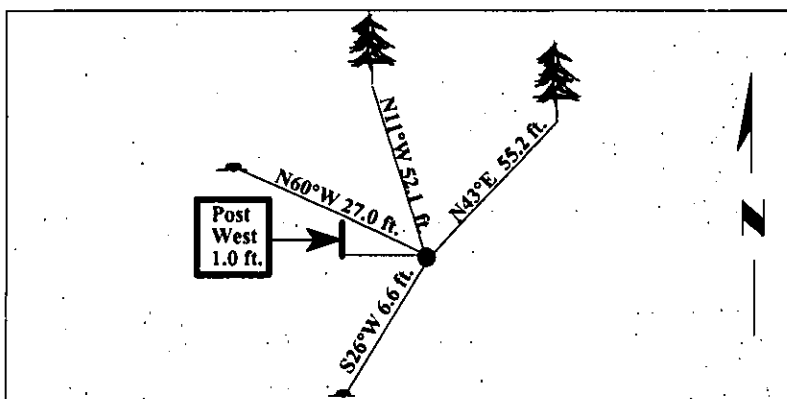

SKETCH OF CORNER

CERTIFICATION

I, Rex O. Rice
certify the information shown herein is true and correct.

I, Ronald A. Pearson
certify that this Corner Record correctly represents work performed by me or under my direction in compliance with the "Corner Recordation Act" (70-22-101, et seq., M.C.A.)

Signature of Surveyor & Seal

Date: 05/01/97

Reg. No.: 9008LS

Employer: U.S. FOREST SERVICE

Office of Clerk and Recorder, County of LINCOLN. This "corner record" was filed for record on JULY 31, 1997 was noted on the cross-index plat and is assigned page No. 9892 in book No. CORAL M. CUMMINGS

County Official

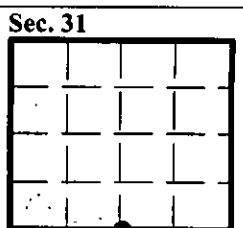

• corner this sheet

Cross Index No. Z-3 T. 37N R. 27W P.M., MT

Adopted July 1, 1981, Montana Board of Professional Engineers & Land Surveyors