

CERTIFIED CORNER RECORDATION

Corner C.O.E. 5601/1-1 Sec. 19&20 T. 37N R. 27W P.M., MT Lincoln County

- I. 1970 Corp. of Engineers Libby Dam Lake Koocanusa Cadastral District file No. E 53-1-154: For corner no. 1 of tract 5601-1, set a standard U.S.C.E. disk, mkd. as shown:

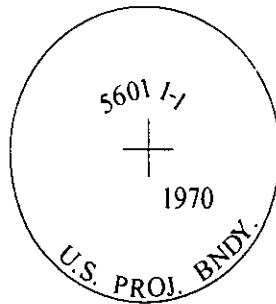

- II. Found a 3 1/2 in. diam., Corps of Engineers brass cap, set flush with the ground, in concrete, mkd. as shown above. No bearing trees found.

- III. Established two bearing trees:

A pine, 18 ins. diam., bears S50°W, 58.7 ft. dist., mkd. "S1/16 S19 BT".
A pine, 14 ins. diam., bears S01°E, 70.15 ft. dist., mkd. "S1/16 S20 BT".

Painted bearing trees and attached Land Survey Monument and Bearing Tree signs.
A 4 ft. tall, metal fence post, bears S23°W, 2.3 ft. dist. from the corner.

Magnetic Declination: 20° East.

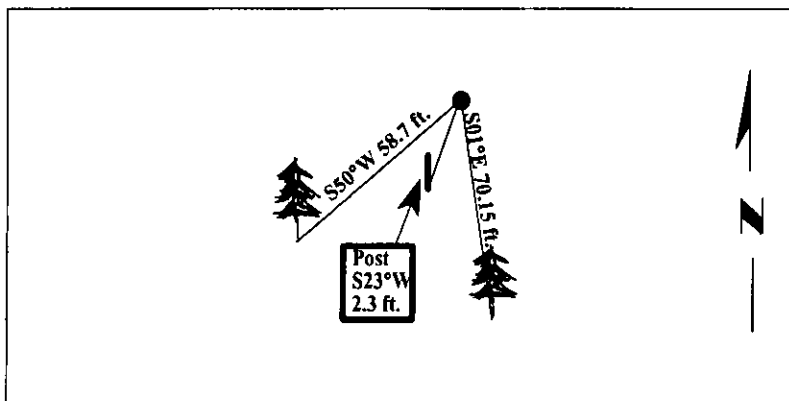

SKETCH OF CORNER

CERTIFICATION

I, Rex O. Rice
certify the information shown herein is true and correct.

I, Ronald A. Pearson
certify that this Corner Record correctly represents work performed by me or under my direction in compliance with the "Corner Recordation Act" (70-22-101, et seq., M.C.A.)

Ronald A. Pearson
Signature of Surveyor & Seal

Date: 04/17/97

Reg. No.: 9008LS

Employer: U.S. FOREST SERVICE

Office of Clerk and Recorder, County of LINCOLN. This "corner record" was filed for record on JULY 31, 1997 was noted on the cross-index plat and is assigned page No. 9888 in book No. CORAL M. CUMMINGS By eeB
County Official

Sec. 20

| | | | | |
|--|--|--|--|--|
| | | | | |
| | | | | |
| | | | | |
| | | | | |
| | | | | |

• - corner this sheet

Cross Index No. C.O.E. 5601/1-1 T. 37N R. 27W P.M., MT