

CERTIFIED CORNER RECORDATION

Corner C.O.E. 5607/1 Sec. 20 T. 37N R. 27W P.M., MT Lincoln County

- I. 1970 Corp. of Engineers Libby Dam Lake Koocanusa Cadastral District file No. E 53-1-154: For corner no. 1 of tract 5607, set a standard U.S.C.E. disk, mkd. as shown:

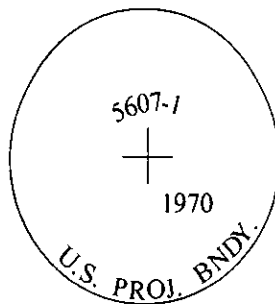

- II. Found a 3 1/2 in. diam., Corps of Engineers brass cap, set 2 ins. below the ground surface, in concrete, mkd. as shown above. No bearing trees found.

- III. Established two bearing trees and a steel guard post:

A pine, 13 ins. diam., bears N45°W, 28.3 ft. dist., mkd. "C.O.E. 5607/1 BT".
 A pine, 12 ins. diam., bears S71°W, 40.6 ft. dist., mkd. "X" on snowblaze "BT".
 A 6 ft. steel post, North, on property line, 3.0 ft. dist. from the corner.

Painted bearing trees and attached Land Survey Monument and Bearing Tree signs.
 Attached Land Survey Monument decals to the post.

Magnetic Declination: 20° East.

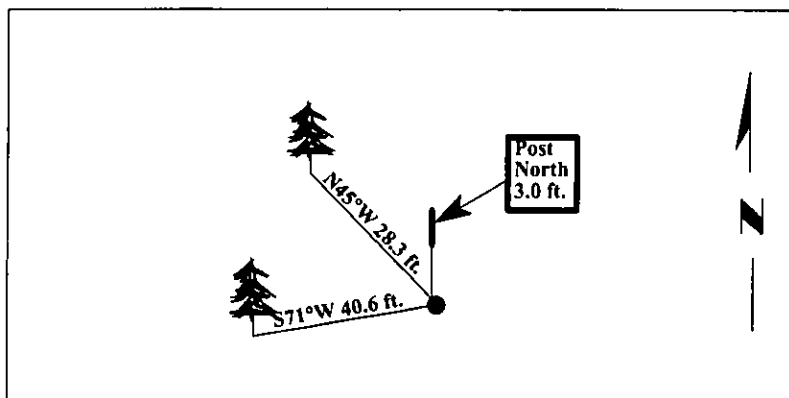

SKETCH OF CORNER

I. Rex O. Rice
 certify the information shown herein is true and correct.

I. Ronald A. Pearson
 certify that this Corner Record correctly represents work performed by me or under my direction in compliance with the "Corner Recordation Act" (70-22-101, et seq., M.C.A.)

Ronald A. Pearson
 Signature of Surveyor & Seal

Date: 04/17/97

Reg. No.: 9008LS

Employer: U.S. FOREST SERVICE

Office of Clerk and Recorder, County of LINCOLN. This "corner record" was filed for record on JULY 31, 1997 was noted on the cross-index plat and is assigned page No. 9887 in book No. CORAL M. CUMMINGS By DEB

County Official

Sec. 20

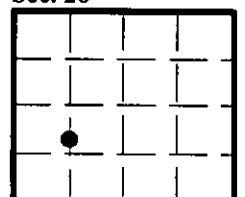

• - corner this sheet

Cross Index No. C.O.E. 5607/1 T. 37N R. 27W P.M., MT