

CERTIFIED CORNER RECORDATION

Corner C.O.E. Sec. 20 T. 37N R. 27W P.M., MT Lincoln County
5612/2

- I. 1972 Corp. of Engineers Libby Dam Lake Koocanusa Cadastral District file No. E 53-1-154: For corner no. 2 of tract 5612, set a standard U.S.C.E. disk, mkd. as shown:

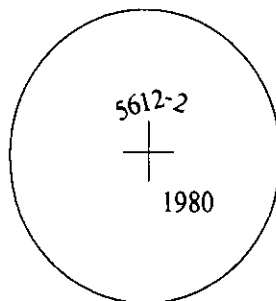

- II. Found a 3 1/2 in. diam., Corps of Engineers brass cap, firmly set, 4 ins. below the surface of the ground, and mkd. as shown above.
- III. Established two bearing trees:

A pine, 13 ins. diam., bears S12°W, 32.7 ft. dist., mkd. "X" on snowblaze "BT".
A pine, 5 ins. diam., bears S72°W, 12.0 ft. dist., mkd. "C.O.E. 5612-2 BT".

Painted bearing trees and attached Land Survey Monument and Bearing Tree signs.
Corner falls near the Murray Springs Hatchery.

Magnetic Declination: 20° East.

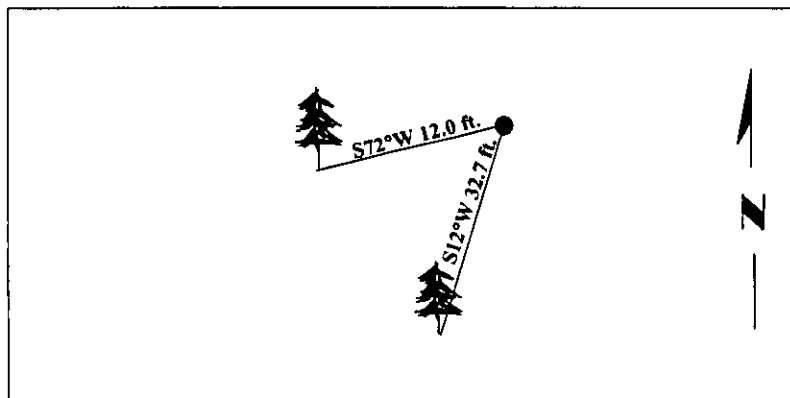
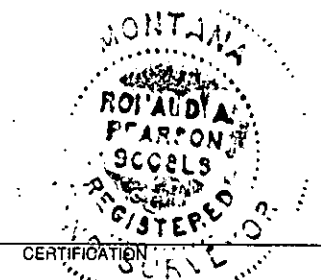

SKETCH OF CORNER

CERTIFICATION

I, Rex O. Rice
certify the information shown herein is true and correct.

I, Ronald A. Pearson
certify that this Corner Record correctly represents work performed by me or under my direction in compliance with the "Corner Recordation Act" (70-22-101, et seq., M.C.A.)

Ronald A. Pearson
Signature of Surveyor & Seal

Date: 04/17/97

Reg. No.: 9008LS

Employer: U.S. FOREST SERVICE

Office of Clerk and Recorder, County of LINCOLN. This "corner record" was filed for record on JULY 31, 1997 was noted on the cross-index plat and is assigned page No. 9885, in book No. _____

CORAL M. CUMMINGS

County Official

Sec. 20

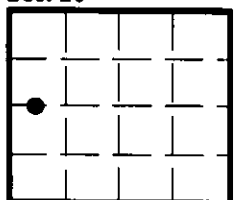

• - corner this sheet

Cross Index No. C.O.E. T. 37N R. 27W P.M., MT
5612/2