

CERTIFIED CORNER RECORDATION

Corner C.O.E. Sec. 20 T. 37N R. 27W P.M., MT Lincoln County
5612/1

- I. 1972 Corp. of Engineers Libby Dam Lake Koocanusa Cadastral District file No. E 53-1-154: For corner no. 1 of tract 5612, set a standard U.S.C.E. disk, mkd. as shown:

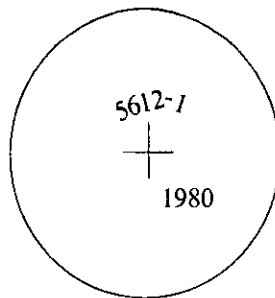

- II. Found a 3 1/2 in. diam., Corps of Engineers brass cap, set flush with the ground, in concrete, mkd. as shown above.

- III. Established two bearing trees:

A pine, 12 ins. diam., bears N30°W, 23.3 ft. dist., mkd. "X" on snowblaze "BT".
A pine, 12 ins. diam., bears S86°W, 52.2 ft. dist., mkd. "CW 1/16 S20 BT".

Painted bearing trees and attached Land Survey Monument and Bearing Tree signs.
A 4 ft. tall metal fence post, set in concrete, located East, 0.6 ft. dist. from the corner.
Corner falls near the Murray Springs Hatchery.

Magnetic Declination: 20° East.

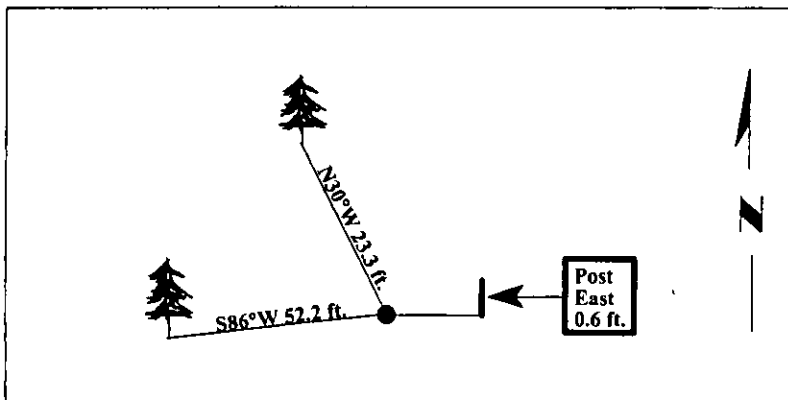

SKETCH OF CORNER

I. Rex O. Rice
certify the information shown herein is true and correct.

I. Ronald A. Pearson
certify that this Corner Record correctly represents work performed by me or under my direction in compliance with the "Corner Recordation Act" (70-22-101, et seq., M.C.A.)

Signature of Surveyor & Seal

Date: 04/17/97

Reg. No.: 9008LS

Employer: U.S. FOREST SERVICE

Office of Clerk and Recorder, County of LINCOLN. This "corner record" was filed for record on JULY 31, 1997 was noted on the cross-index plat and is assigned page No. 9884 in book No. _____

CORAL M. CUMMINGS
County Official

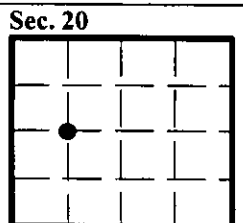

• - corner this sheet

Cross Index No. C.O.E. T. 37N R. 27W P.M., MT
5612/1