

INSTRUCTIONS

1. Original and/or subsequent record used to evaluate the corner position.
2. Description of evidence found, note discrepancies in the record, state method of establishing lost or obliterated corners.
3. Description of monument and accessories set to perpetuate the corner position.
4. Sketch of corner, show all pertinent data which can best be shown in a sketch example, corner marking, topography ties, position of accessories, etc.
5. Certification must be signed and sealed by Registered Land Surveyor in State of Montana.
6. Fill in Cross Index & Section Diagram at bottom of sheet.

CERTIFIED CORNER RECORDATION

Corner 1/4 corner between S 34 & 35 T. 37N R. 27W P.M.M. Lincoln County

Record:

Set a limestone 14x10x4 "10" in the ground for 1/4
sec. cor. marked 1/4 on West face

Dug pits N & S of stone

No evidence found. Set brass cap at intersection of
fence line & E of County Road.

See C. of S. No. 541 for adjacent corners.

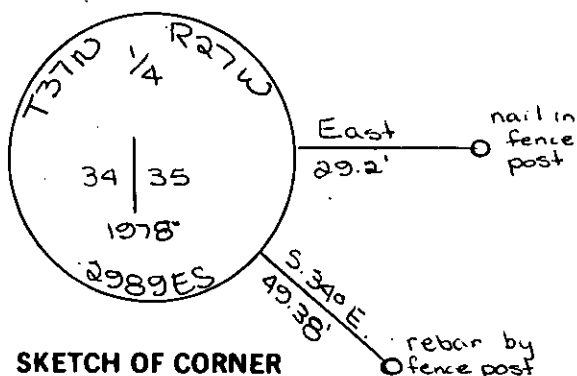

SKETCH OF CORNER

CERTIFICATION

I, _____
certify the information shown herein is true and correct.

Signature Ground Party Chief

I, D.K. Macquardt
certify that this Corner Record correctly represents work performed
by me or under by direction in compliance with the "Corner
Recordation Act" (70-22-101, et seq., M.D.A.)

D.K. Macquardt
Signature of Surveyor & Seal

Date: 7-6-81 Reg. No. 2289ES

Employer: _____

Office of Clerk and Recorder, County of Lincoln. This "corner
record" was filed for record on the 17th July day of 1981,
was noted on the cross-index plat and is assigned page No. 1163 in
book No. 1

Blaine L. Vaughn, by Betty Bell,
County Official Deputy

Cross Index No. X-17 T. 37N R. 27W P.M.M.

Sec. 34

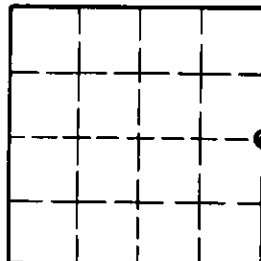

• - corner this sheet