

INSTRUCTIONS

1. Original and/or subsequent record used to evaluate the corner position.
2. Description of evidence found, note discrepancies in the record, state method of establishing lost or obliterated corners.
3. Description of monument and accessories set to perpetuate the corner position.
4. Sketch of corner, show all pertinent data which can best be shown in a sketch example, corner marking, topography etc., position of accessories, etc.
5. Certification must be signed and sealed by I, and Surveyor licensed in the State of Montana.
6. Fill in Cross Index & Section Diagram at bottom of sheet.
- 7.

CERTIFIED CORNER RECORDATION

Corner SEC C&R 11,12,14,13 T. 37N R. 27W P.M.M. LINCOLN County

1893 GLO RECORD: Set a Sand stone, 18x10x4 ins. 12 ins. in the ground, for Cor. to Secs. 11, 12, 13 & 14 marked with 4 notches on S and 1 notch on E edges. Dug pits 18x18x12 ins. in each Sec. 5 1-2 ft. dist. and raised a mound of earth 2 ft. high, 4 1-2 ft. base alongside.

1977 BLM REMONUMENTATION: Set an iron post, 30 ins. long, 2 ½ ins. diam., 22 ins. in the ground, with brass cap mkd.

T37N R27W

S11	S12
S14	S13

1977

bury the original stone alongside and raise a flat mound of stone, 2 ½ ft. diam., around iron post. Corner is situated 3 lks. dist., E. of a fence extending N and S.

FOUND: a 1977 BLM brass cap on iron pipe 6 ins. out of ground, marked as shown above.

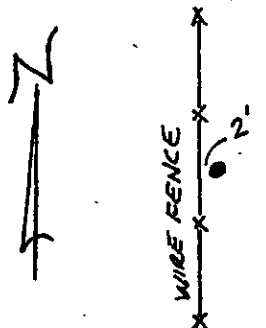

SKETCH OF CORNER

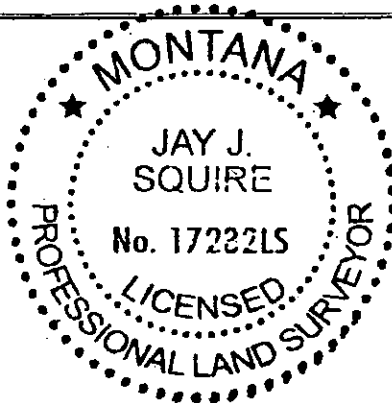

CERTIFICATION

I, _____
certify the information shown herein is true and correct.

Signature: Ground Party Chief
I, JAY J. SQUIRE
certify that this Corner Record correctly represents work performed by me or under my direction in compliance with the "Corner Recordation Act" (M-22-101, et seq., M.C.A.)

Signature of Surveyor & Seal
JAY J. SQUIRE
Date: 11/1/2007 Reg. No. 17282 LS
Employer SELF

208462 BOOK: CCR CC&R'S PAGE: 11184 Pages: 1 Sec. 12
Office of Clerk and Recorder
"record" was filed for record
was noted on the cross-index
book No. _____
STATE OF MONTANA LINCOLN COUNTY
RECORDED: 01/04/2008 10:00 KOI: CC&R'S
TAMMY D. LAUER CLERK AND RECORDER
FEE: \$0.00 BY: Jay J. Squire
TO: JAY SQUIRE
County Official

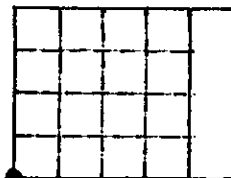

* - corner this sheet

Cross Index No. J-21 T. 37N R. 27W PMM