

CERTIFIED CORNER RECORDATION

Corner 1/4 Secs. 7 & 8 T. 37N R. 26W P.M., MT Lincoln County

- I. 1908 G.L.O. Record by Angell H. Oakes: Set a quartzite stone, 18x16x12 ins., 12 ins. in the ground, for 1/4 sec. cor., mkd. "1/4" on the W. face.

Established two bearing trees:

A spruce, 10 ins. diam., bears N81 1/2°E, 28 lks. dist., mkd "1/4 S8 BT".

A birch, 10 ins. diam., bears N64 1/2°W, 32 lks. dist., mkd "1/4 S7 BT".

1981 Certified Corner Recordation by William W. Weikel, No. 4731S: Found stone of correct size, with possible "1/4" lying beside road, and witnessed by the remains of the original bearing trees. At the corner point, set a 2 1/2 in. diam., 30 ins. long, aluminum pipe, with a 3 in. diam. aluminum cap, mkd. as shown.

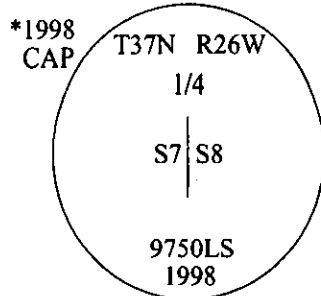
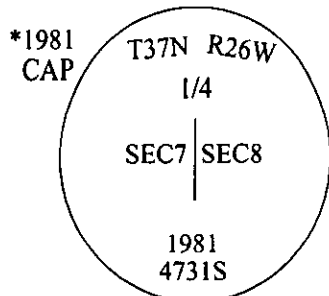

Established two new bearing trees.

- II. Found a 2 1/2 in. diam. aluminum pipe, bent, but in place, with cap ripped off and witnessed by the remains of one original bearing tree and the 1981 bearing trees.

from which:

A fir, 6 ins. diam., bears N37°E, 9.1 ft. dist., with visible scribe. (1981-record)

A fir, 16 ins. diam., bears N40°W, 50.3 ft. dist., with visible scribe. (1981-record)

A stump, bears N66°W, 27.5 ft. dist., with no visible scribe. (GLO-record-N64 1/2°W)

- III. I replace the destroyed monument, with a 2 1/2 in. diam., 30 ins. long aluminum pipe, 26 ins. in the ground, with a 3 1/4 in. diam. aluminum cap, mkd. as shown above.

*Reference: The corner is on the East edge of Road.

Painted bearing trees and attached Land Survey Monument and Bearing Tree signs.

Magnetic Declination: 20° East

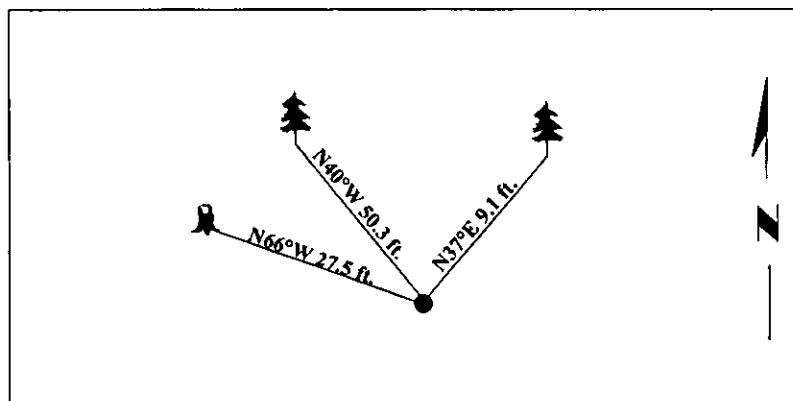

SKETCH OF CORNER

CERTIFICATION	
I. <u>Mark Federman</u>	certify the information shown herein is true and correct.
I. <u>Steven A. Boyer</u>	certify that this Corner Record correctly represents work performed by me or under my direction in compliance with the "Corner Recordation Act" (70-22401, et seq., M.C.A.)
Date: <u>6/30/98</u>	Signature of Surveyor & Seal
Reg. No.: <u>9750LS</u>	
Employer: <u>U.S. FOREST SERVICE</u>	

Office of Clerk and Recorder, County of Lincoln. This "corner record" was filed for record on 11-18-98 and was noted on the cross-index plat and is assigned page No. 10273 in book No. .

Coral M. Cummings
County Official

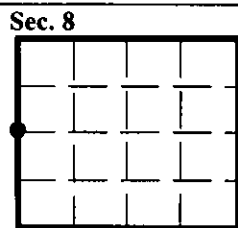

● - corner this sheet