

INSTRUCTIONS

1. Original and/or subsequent record used to evaluate the corner position.
2. Description of evidence found, note discrepancies in the record, state method of establishing lost or obliterated corners.
3. Description of monument and accessories set to perpetuate the corner position.
4. Sketch or corner, show all pertinent data which can best be shown in a sketch example, corner marking, topography lies, position of accessories, etc.
5. Certification must be signed and sealed by Registered Land Surveyor in State of Montana.
6. Fill in Cross Index & Section Diagram at bottom of sheet.

CERTIFIED CORNER RECORDATION

Cor. No. 4 HES 1179
 Corner Cor. No. 7 HES 431 T. 35,36N R. 32W Lincoln P.M.M. County

Record: Cor. #7 HES 431: I set for Corner No. 7, a small stone marked with a cross (X) under a slate stone 27 X 16 X 6 inches, 17 inches in the ground, marked 7 H.E.S. 431 on SW face, and a cross (X) on top for the exact corner point. No bearings available, therefore dig pits 24 X 24 X 12 inches crosswise on this and the succeeding course, 7 feet distance, and raise a mound of earth, 4 foot base, 2 feet high, SW of corner.

Cor. #4 HES 1179 A slatestone 10 X 16 X 6 inches above ground, I adopt this corner for corner No. 4 of this survey, and mark it 4 H.E.S. 1179 on the S.E. face.

The cross (X) on stone is the exact corner point, from which A cross (X) on a Lodgepole Pine tree 5 inches diameter bears S.52°00'E. 60 links distance (new BT)

A cross (X) on a Lodgepole Pine tree 5 inches diameter bears S 13°00'E. 36 links distance (new BT), each blazed and scribed 4 H.E.S. 1179 BT.

Raise a mound of earth 4 foot base, 2 feet high, S.E. or cor.

Found: A stone 27" X 10" X 6" 10" above the ground with an X on top. Scribed 4 HES 1179 on SE face and 7 HES 431 on SW face from which,
 An 8" Larch bears S 87½°W 54 links. Posted
 An 8" Pine bears S 38°W 25 links. Posted

Set: Changed bearing on BT signs accordingly.
 Painted monument and accessories with bright red paint.

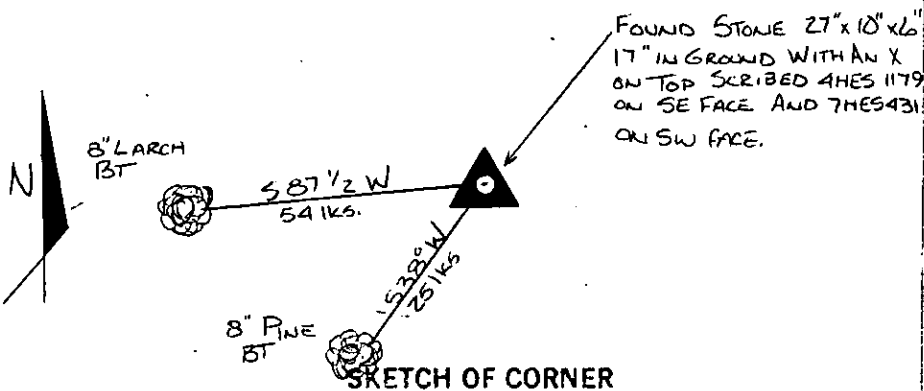
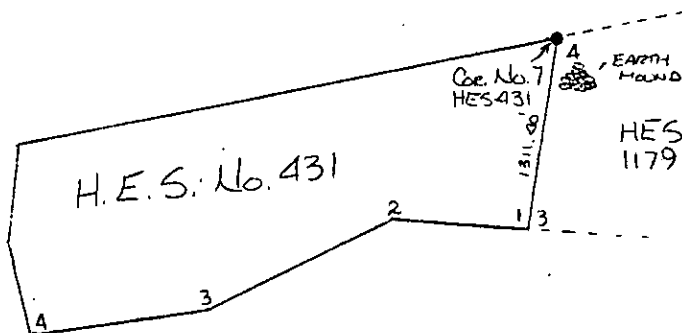

FOUND STONE 27" X 10" X 6"
 17" IN GROUND WITH AN X
 ON TOP SCRIBED 4HES 1179
 ON SE FACE AND 7HES 431
 ON SW FACE.

CERTIFICATION
 Jack H. Ninneman

I, _____
 certify the information shown herein is true and correct.

Jack H. Ninneman
 Signature of Surveyor & Seal
 Jack H. Ninneman

I, _____
 certify that this Corner Record correctly represents work performed
 by me or under my direction in compliance with the "Corner
 Recordation Act" (70-22-101, et seq., M.D.A.)

Jack H. Ninneman
 Signature of Surveyor & Seal

Date: Dec. 82 Reg. No. 4661S

Employer: Ninneman Engineering Inc.

Office of Clerk and Recorder, County of LINCOLN. This "corner
 record" was filed for record on the DEC. 30 day of 1982
 was noted on the cross-index plat and is assigned page No. 2124, in
 book No. _____
Eleanor L. Vaughn by Betty L. Conces
 County Official deputy

Sec.	
HES 431	
UNSURVEYED	
SECTION	

Cross Index No. _____ T. 35 N R. 32 W P.M.M.

• - corner this sheet