

**CERTIFIED CORNER RECORDATION**

Corner No. 6 HES 1185 T. 36 N., R. 31 W., P.M.M. Lincoln County

**Record :**

1922 HES Survey by J.F. Pfau.

"Intersect Cor. 2 of accepted HES No. 1060, identical with Cor. No. 4 of patented HES No. 282, which is an iron post 12 in. above ground, 2 ins. diam., with a brass cap, marked and witnessed as described by the Surveyor General. I adopt this corner for Cor. No. 6 of this survey, and mark it 6 H.E.S. 1185. From the point on the cor. which is the exact cor. point:

A cross (x) on a Tamarack tree 24 ins. diam. bears N 46°00' E 7 lks. dist. (new BT).

A cross (x) on a Lodgepole Pine tree 6 ins. diam. bears N 50°00' W 34 lks. dist. (new BT), each blazed and scribed 6 H.E.S. 1185 BT."

Raised a mound of earth 4 ft. base, 2 ft. high N. of cor."

**Found Evidence :**

Found a 2 inch diam. steel pipe with a 2 ½ inch diam. brass cap 12 ins. above ground, marked as shown below:

A Lodgepole Pine snag bears N 49° W (N 50° W record) 22.40 feet dist., with visible scribing.

A Larch stump bears N 43°30' E (N 46° E record) 4.62 feet dist., with visible scribing.

A mound of earth bears north of corner.

### Perpetuation :

I accept the above marked brass cap for Cor. No. 6 HES 1185.

**We established two new Bearing Trees described as follows:**

A Spruce 4 ins. diam. bears N 55° W 26.30 ft. dist. scribed "BT" at the base, with a scribed "X" chest height.

A Larch 16 ins. diam. bears N 40° E 13.80 ft. dist. scribed "6 HES 1185 BT".

Painted both scribed faces red and 6 inch wide bands around both trees.

**Set a steel post 2 ft. southeasterly of monument with attached monument and property line stickers.**

**Attached land survey monument and Bearing Tree signs to both trees.**

**Magnetic Declination: 18° E**

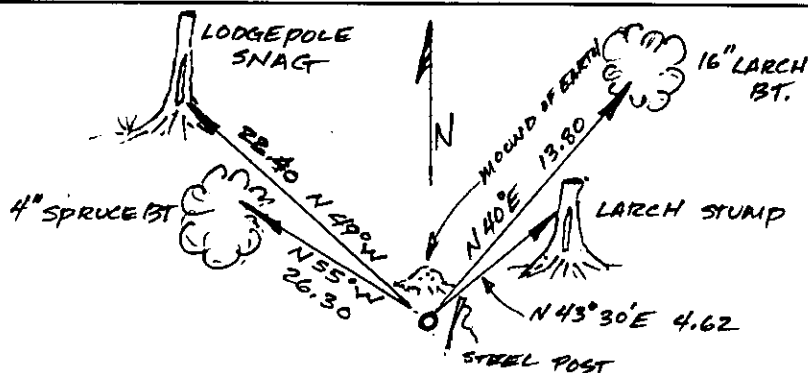

## CERTIFICATION

I, John Damon

certify the information shown herein is true and correct

John Daxon

**Signature of Ground Party Chief**

I, Ken E. Davis

certify that this Corner Record correctly represents work performed by  
me or under my direction in compliance with the "Corner Recordation Act"  
(70-22-101, et seq., M.C.A.)

Signature: E. Davis DAVIS  
4975 S

Date: 6/17/97 Reg. No.

Employer: Davis Surveying, Inc.

### Sketch of Corner

Office of Clerk and Recorder, County of LINCOLN

This "corner record" was filed for record on 6-30-97

was noted on the cross-index plat and is assigned page No. 0257.

in <sup>PAGE</sup>book No. 9257

**CORAL M. CUMMINGS**

County Official

Section 20

(UNSURVEYED)

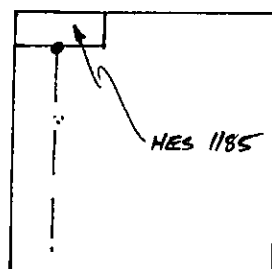

Cross Index No. Cor. 6 HES 1185 T. 36 N., R. 31 W., PMM • THIS CORNER