

CERTIFIED LAND CORNER RECORDATION

PART OF H.E.S. NO. 8* IN UNSURVEYED SECTION 7, TOWNSHIP 36 NORTH, RANGE 31 WEST, M.P.M.

DESCRIPTION OF CORNER EVIDENCE FOUND, AND ORIGINAL RECORD (IF KNOWN)

Corners pertinent to this survey shown and described on other side.

DESCRIPTION OF MONUMENT AND ACCESSORIES ESTABLISHED TO PERPETUATE THE ORIGINAL LOCATION OF THIS CORNER:

Date of work: Sept. 1977

Descriptions of corners established shown on diagram on other side.

SKETCH, WITH COURSE AND DISTANCE TO ADJACENT CORNERS IF DETERMINED IN THIS SURVEY. (MAY SKETCH OR PASTE REPRODUCTION ON REVERSE SIDE.)

SEE DIAGRAM ON OTHER SIDE

Surveyor's Seal



I, Jack H. Ninneman, certify that the information shown herein is true and correct.

Jack H. Ninneman
Signature of Ground Party Chief

I, Jack H. Ninneman, certify that I have carefully performed or reviewed the work done on the diagrammed corner as reported on this recordation form and approve the same.

Jack H. Ninneman
Signature of Surveyor

DIAGRAM OF CORNER:

See reverse side
N. HES No. 486

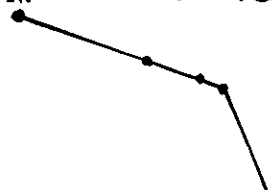

● = Corner recorded on the sheet

Registration Number

Office of Clerk and Recorder, County of Lincoln

This "corner record" was filed for record on the 17th day of May, 1978, was noted on the cross-index plat and is

assigned page No. 523, in book No. 1

Eleanor L. Vaughn by Dorothy Martin
County Official

Sec. Twp. 36 N., R. 31 W., M.P.M.

77

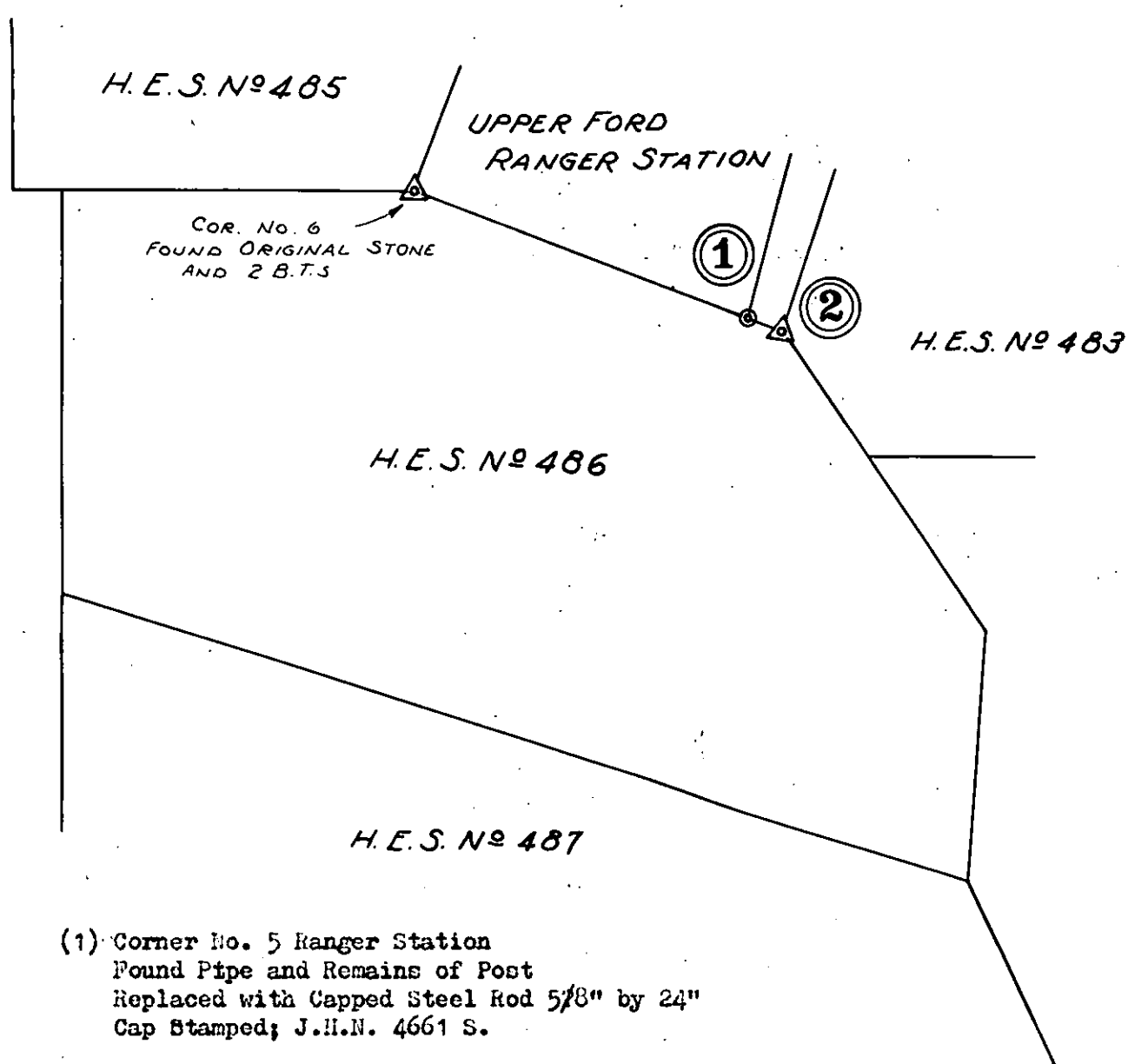

- (1) Corner No. 5 Ranger Station
Found Pipe and Remains of Post
Replaced with Capped Steel Rod 5/8" by 24"
Cap Stamped; J.H.N. 4661 S.
- (2) Corner No. 1 H.E.S. 486
Found Original Stone (Washed Out) and 2 B.T.s
Reset Stone Alongside Capped 5/8" by 24" Steel Rod
Cap Stamped: J.H.N. 4661 S.