

CERTIFIED CORNER RECORDATION

Corner SE SEC. COR. Sec. 25 T. 36 N R. 28 W P.M., MT. Lincoln County

- I. 1893 Original G.L.O. survey by Peter McCardell and Abraham L. Jaqueth: Set a limestone and four bearing trees.
- 1903 G.L.O. Resurvey and Reestablishment of the Fr. W. bdy. of T36N R27W by A. L. Rinearson et al: Set a porophry stone and four bearing trees. The old sec. cor. which is a stone marked and witnessed as described by the surveyor general, I destroy.
- 1969 B.L.M. remonumentation by Roy G. Leedy: The cor. of secs. 25, 30, 31 and 36, on the W. bdy. of the Tp., monumented with a porphyry stone, 16 x8 x7 ins., firmly set, mkd. 5 notches in the N., and 1 notch on the S. edges, and witnessed by the remains of the original bearing trees:
- A stump, bears N 34 1/4°E, 32 lks. dist., mkd. S S30 BT.
A stump, bears S 46 1/4°E, 98 lks. dist., mkd. W S31 B.
A stump, bears S 71°W, 65 lks. dist., mkd. T36N R28W S36 BT.
A stump, bears N 46 1/2°W, 125 lks. dist., mkd. T. (Record: 25 lks.)

At the corner point:

Set an iron post, 30 ins. long, 2 1/2 ins. diam., 28 ins. in the ground., with brass cap marked:

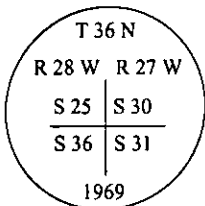

from which:

- A fir, 6 ins. diam., bears N 8 1/2°E, 23 lks. dist. mkd. T36N R27W S30 BT.
A fir, 6 ins. diam., bears S 35°E, 25 lks. dist. mkd. T36N R27W S31 BT.
A fir, 6 ins. diam., bears S 29 1/2°W, 29 lks. dist. mkd. T36N R28W S36 BT.
A fir, 6 ins. diam., bears N 74°W, 39 lks. dist. mkd. T36N R28W S25 BT.
- II. Found an iron pipe., 2 1/2 ins. diam., 8 ins. above ground, firmly set, with a 3 1/4 in. daim. brass cap mkd. as shown above, from which the remainder of the original G.L.O bearing tree stumps and the B.L.M. bearing trees were found as described in the above record.
- A 6 ft. steel post bears SW, 4 ft. dist., with Property Boundary and Land Survey Monument decals attached.
- III. Painted red bands around the bearing trees and attached Land Survey Monument and Bearing Tree signs.
- Magnetic Declination: 20° East.

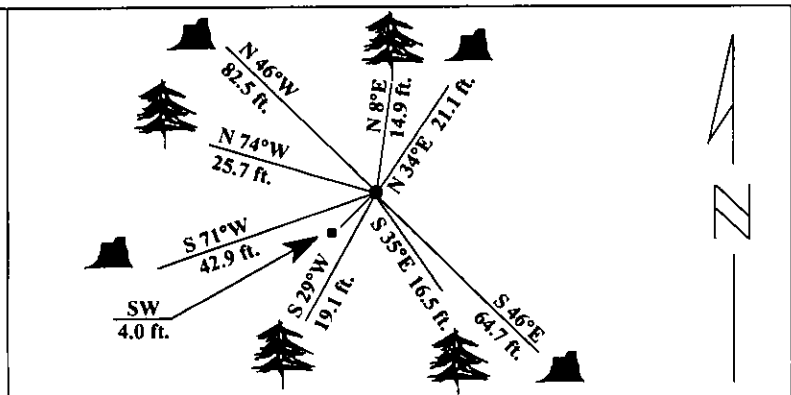

SKETCH OF CORNER

CERTIFICATION

I, Thomas M. Hommel
certify the information shown herein is true and correct.

Signature Ground Party Chief

I, Ronald A. Pearson
certify that this Corner Record correctly represents work performed by me or under my direction in compliance with the "Corner Recordation Act" (70-22-101, et seq., M.C.A.)

Signature of Surveyor & Seal

Date: 1/25/96

Reg. No.: 9008LS

Employer U.S. FOREST SERVICE

Office of Clerk and Recorder, County of LINCOLN. This "corner record" was filed for record on AUG21,1997 was noted on the cross-index plat and is assigned page No. 9908 in book No. CORAL M. CUMMINGS By OLB County Official

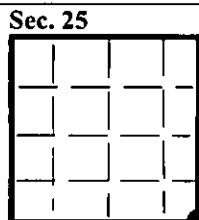

• - corner this sheet