

CERTIFIED LAND CORNER RECORDATION

1/4 Corner between Sections 32 and 33 Twp. 36 N., R. 28 W., M.P.M.

DESCRIPTION OF CORNER EVIDENCE FOUND, AND ORIGINAL RECORD (IF KNOWN)

Original record 1903 - Corner description
A limestone 14"x 9" x 5" - 9" in ground mkd. 1/4 on W. face from which
A 32" fir on line 32 lks North mkd. two notches on N. and S.
A 12" fir bears S 44 1/2 E 55 lks. mkd 1/4 S 33 BT
A 30" pine bears S 30 W 27 lks. mkd. 1/4 S 32 BT
AUGUST 1966 -- Exhaustive search -- failed to find original stone
Point falls on small flat bench about 8' E.&W. and 20' N.&S. between two
small cliffs about 8' high. The 32" fir reported on line 32 lks. north of
the corner is live but dying (The top is dead) Two notches on north and
south plain and unmistakeable. The SE BT reported a 12" fir is now 26" in
dia. We chopped out the blaze - marked as reported. We tagged with standard
BT sign. SW BT as reported was evidently an error no evidence of such a
tree but remains of large fir NW of corner - possibly original BT.
SEE OTHER SIDE

DESCRIPTION OF MONUMENT AND ACCESSORIES ESTABLISHED
TO PERPETUATE THE ORIGINAL LOCATION OF THIS CORNER:

Date of work: Aug. 1966

SEE OTHER SIDE

SKETCH, WITH COURSE AND DISTANCE TO ADJACENT CORNERS IF DETERMINED IN THIS SURVEY.
(MAY SKETCH OR PASTE REPRODUCTION ON REVERSE SIDE.)

SEE OTHER SIDE

Surveyor's Seal

I, Jack Ninneman
certify that the information shown herein is true and
correct

Jack Ninneman
Signature of Ground Party Chief

I, Jack Ninneman
certify that I have carefully performed or reviewed the
work done on the diagrammed corner as reported on this
recording form and approve the same.

Jack Ninneman 534 ES
Signature of Surveyor

534 ES.
Registration Number

DIAGRAM OF CORNER:

N.
32 33
T. 36 N. R. 28 W.

I = Corner recorded on the sheet

Office of Clerk and Recorder, County of Lincoln

This "corner record" was filed for record on the 5th day of January 19 67, was noted on the cross-index plat and is
assigned page No. 57, in book No. 1
ELEANOR L. VAUGHN, Verda Blighen
County Official

At 36.3 feet from the SE bearing tree and 21 feet from the large fir line tree we set a standard monument with a brass cap marked thus:

on bedrock in a large mound of stone

T. 36 N. R. 28 W.
 1/4 32 } 33 1/4
 1966

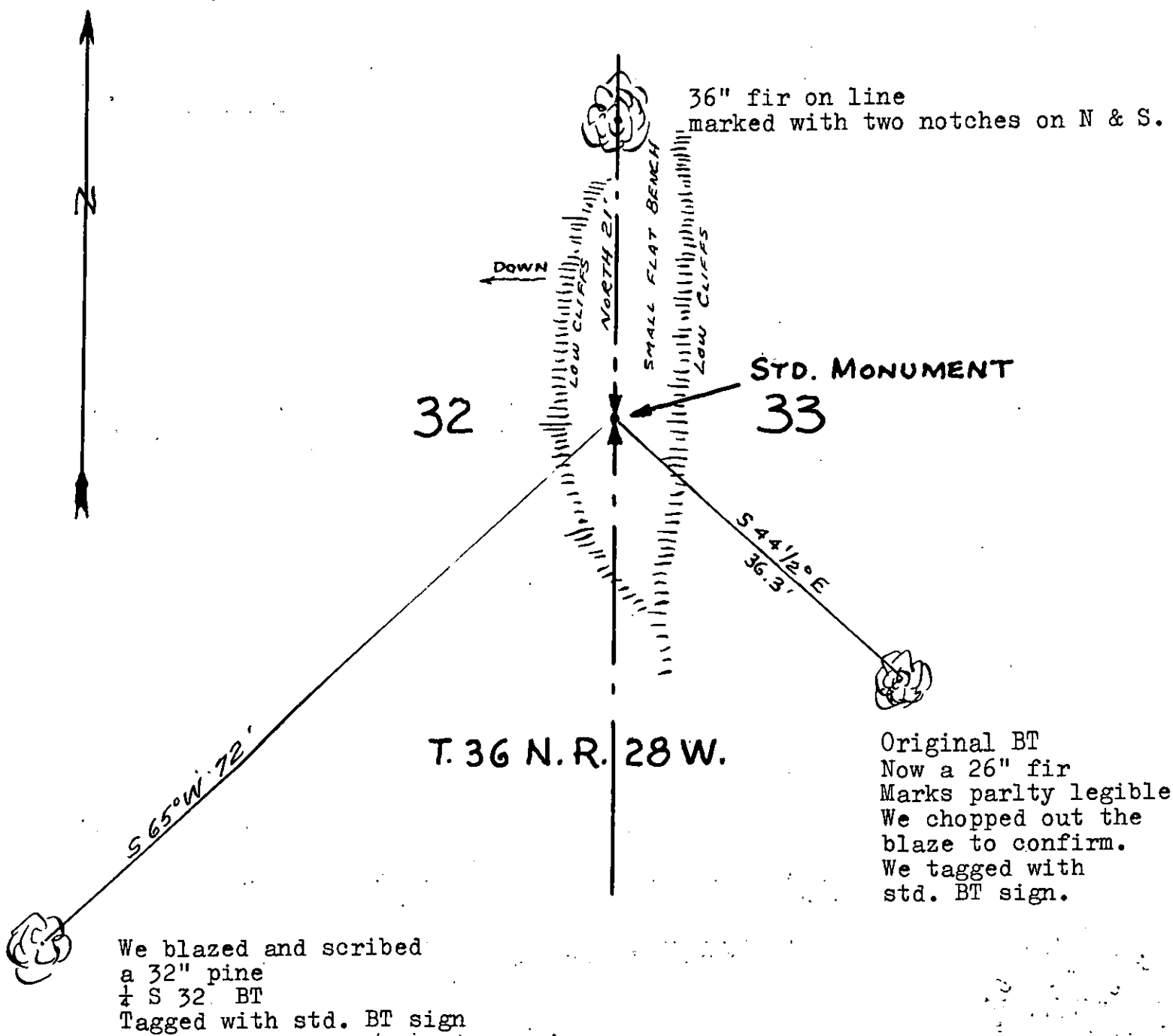

STATE OF MONTANA
 COUNTY OF LINCOLN
 Filed this 5th day of
 January 1967
 A. D. 1967
 By *William J. Laughlin*
 County Clerk
 Deputy