

CERTIFIED CORNER RECORDATION

Corner COE 2905-1 Sec22 T. 36N R. 28W P.M.M. Lincoln County

1. Libby Dam - Lake Kookanusa Cadastral 1972 map

2. Found:

- A 3 1/4" USFS Aluminum Cap on 3/4" Alum. Rod, stamped as shown. (2905-1)
- A 3 1/4" USFS Aluminum Cap on 3/4" Alum. Rod, stamped as shown. (W1/16 CC)
- bears N19°26'W, 3.58 ft. of COE 2905-1.

3. Painted red bands around BTs and attached LSM and BT signs.

Established:

- An 8 ins. Douglas Fir bears S11°E, 37.3 ft. distant, scribed "2905-1 BT"
- A 9 ins. Douglas Fir bears S71°W, 26.6 ft. distant, scribed "2905-1 BT"
- Steel post with PB & LSM sign bears North, 2.0 ft. distant.

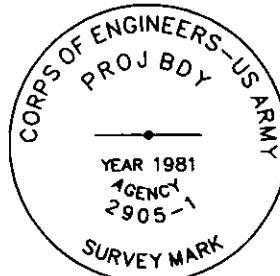
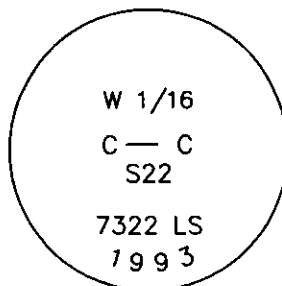

MAGNETIC DECLINATION - 16° EAST

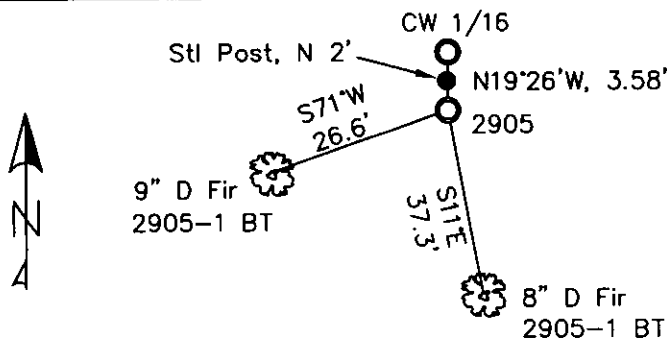

CERTIFICATION

I, ERICH SCHRACK
certify the information shown herein is true and correct.

I, LAWRENCE A. GLAHE
certify that this Corner Recordation represents work performed by me or under my direction in compliance with the "Corner Recordation Act" (MCA 19-22-101, et seq. M.C.A.)

Date: 1-25-10 9748 LS
Employer: GLAHE & ASSOCIATES, INC.

SKETCH OF CORNER

Office of Clerk and Recorder, County of Lincoln. This "corner

record" was filed for record on 224190 BOOK: CCR CC&R'S PAGE: 11424 Pages: 1

was noted on the cross-index STATE OF MONTANA LINCOLN COUNTY

book No. TAMMY D. LAUER CLERK AND RECORDER

FEE: \$0.00
TO: FILED

BY: Deanne Perry

Cross Index No. P-14 T. 36N R. 28W PMM

Adopted July 1, 1981, Montana Board of Professional Engineers & Land Surveyors

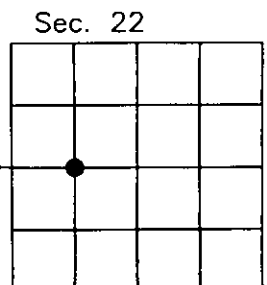

● corner this sheet