

CERTIFIED CORNER RECORDATION

Corner COE 3123-2 Sec 15 T. 36N R. 28W P.M.M. Lincoln County

1. Libby Dam - Lake Kookanusa Cadastral 1972 map
2. Found 3 1/2" Corps of Engineers Brass Cap in 4" concrete stamped as shown.
3. Painted red bands around BTs and attached LSM and BT signs.

Established:

An 11 ins. Douglas Fir bears S37°W, 16.2 ft. distant, scribed "3123-2 BT"
 An 11 ins. Douglas Fir bears N45°W, 6.0 ft. distant, scribed "3123-2 BT"
 Steel posts with LSM and PB signs, bear NE and S, 2 ft. dist.

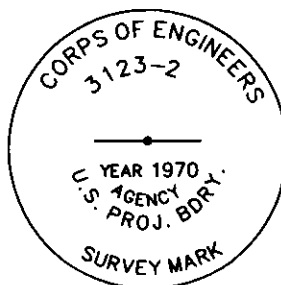

MAGNETIC DECLINATION - 16° EAST

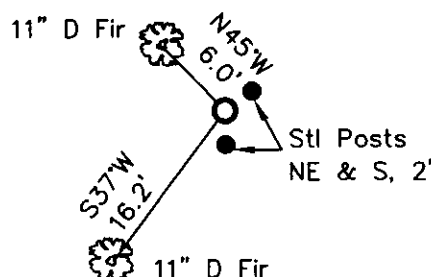
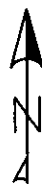

SKETCH OF CORNER

CERTIFICATION

I, ERICH SCHRACK
 certify the information shown herein is true and correct.
 I, LAWRENCE A. GLAHE
 certify that this Corner Recordation represents work performed by me or under my direction in compliance with the "Corner Recordation Act" (MCA 92-1-401, et seq. M.C.A.)
 Date: 1-25-16 9748 LS
 Employer: GLAHE & ASSOCIATES, INC.

Office of Clerk and Recorder, County of Lincoln. This "corner record" was filed for record in 224187 BOOK: CCR CCR'S PAGE: 11421 Pages: 1
 was noted on the cross-index STATE OF MONTANA LINCOLN COUNTY
 book No. TAMMY D. LAUER CLERK AND RECORDER
RECORDED: 01/27/2010 4:02 KOI: CCR'S
TO: FILED BY: [Signature]
FEE: \$0.00

Cross Index No. M-N-N/15-16 T. 36N R. 28W P.M.M.

Adopted July 1, 1981, Montana Board of Professional Engineers & Land Surveyors

Sec. 15

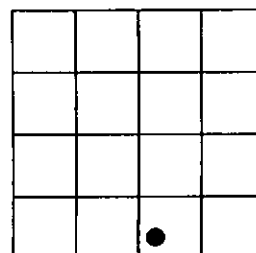

● corner this sheet