

CERTIFIED CORNER RECORDATION

Corner COE 3402 1-2 Sec 11 T. 36N R. 28W P.M.M. Lincoln County

1. Libby Dam - Lake Kookanusa Cadastral 1972 map
2. Found 3" Corps of Engineers Brass Cap in 4" concrete stamped as shown.
3. Painted red bands around BTs and attached LSM and BT signs.

Established:

A 6 ins. Douglas Fir bears S63°W, 6.60 ft. distant, scribed "3402-1-2 BT"
A 12 ins. Douglas Fir bears N8°W, 46.0 ft. distant, scribed "3402-1-2 BT"
Steel post with PB & LSM decals, bears South and Northeast, 2.0 ft. distant.

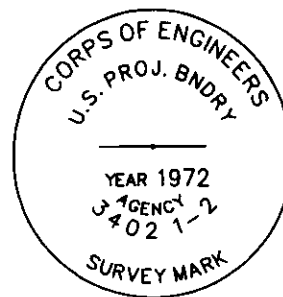

MAGNETIC DECLINATION - 16° EAST

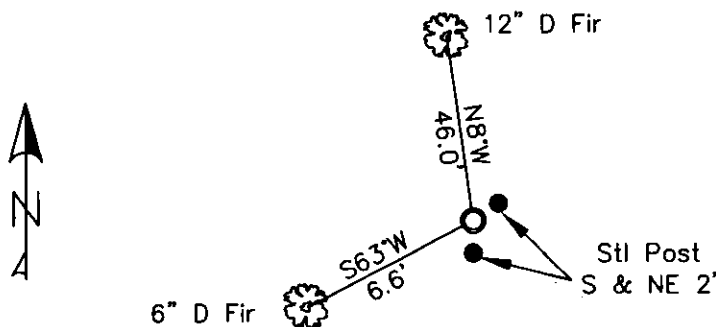

SKETCH OF CORNER

CERTIFICATION

I, ERICH SCHRACK
certify the information shown herein is true and correct.

LAWRENCE A. GLAHE
certify that the Corner Recordation was performed by me or under my direct supervision in compliance with the "Corner Recordation Act" (No. 22-101, et seq. M.C.A.)

Date: 1-25-10 9748 LS
Employer: GLAHE & ASSOCIATES, INC.

Office of Clerk and Recorder, County of Lincoln. This "corner record" was filed for record on 224179 BOOK: CCR CC&R'S PAGE: 11413 Pages: 1
was noted on the cross-index plac STATE OF MONTANA LINCOLN COUNTY
book No. RECORDED: 01/27/2010 3:55 KOI: CC&R'S
TAMMY D. LAUER CLERK AND RECORDER
FEE: \$0.00 BY: [Signature]
TO: FILED

H-J/17-18
Cross Index No. T. 36N R. 28W PMM

Adopted July 1, 1981, Montana Board of Professional Engineers & Land Surveyors

Sec. 11			

● corner this sheet