

CERTIFIED CORNER RECORDATION

Corner COE 3402 1-3 Sec 11 T. 36N R. 28W P.M.M. Lincoln County

1. Libby Dam - Lake Kookanusa Cadastral 1972 map
2. Found 3" Corps of Engineers Brass Cap in 4" concrete stamped as shown.
3. Painted red bands around BTs and attached LSM and BT signs.

Established:

A 10 ins. Douglas Fir bears S88°W, 8.30 ft. distant, scribed "3402-1-3 BT"
A 7 ins. Douglas Fir bears N35°W, 16.30 ft. distant, scribed "3402-1-3 BT"
Steel posts with PB & LSM sign, bear East & SW, 2.0 ft. distant.

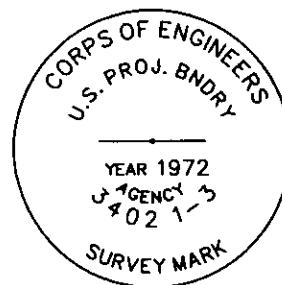

MAGNETIC DECLINATION - 16° EAST

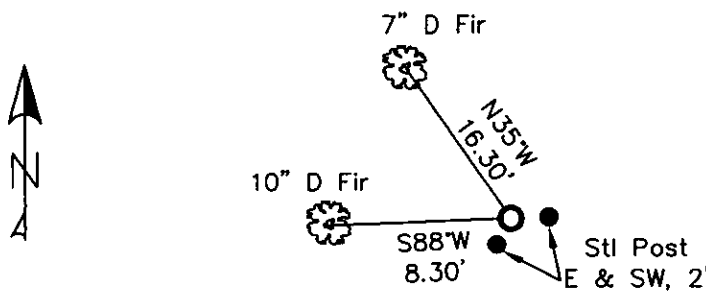

SKETCH OF CORNER

CERTIFICATION

I, ERICH SCHRACK
certify the information shown herein is true and correct.

I, LAWRENCE A. GLAHE
certify that this Corner Record represents work performed by me or under my direction in compliance with the "Corner Resolution Act" (No. 22-101, et seq. M.C.A.)

Date: 1-25-10 9748 LS
Employer: GLAHE & ASSOCIATES, INC.

Office of Clerk and Recorder, County of Lincoln. This "corner

record" was filed for record on - 224178 BOOK: CCR CC&R'S PAGE: 11412 Pages: 1 Sec. 11

was noted on the cross-index pl. RECORDED: 01/27/2010 3:54 KOI: CC&R'S

book No. _____

TAMMY D. LAUER CLERK AND RECORDER
FEE: \$0.00 BY: [Signature]
TO: FILED

Cross Index No. H-J/18 T. 36N R. 28W PMM

Adopted July 1, 1981, Montana Board of Professional Engineers & Land Surveyors

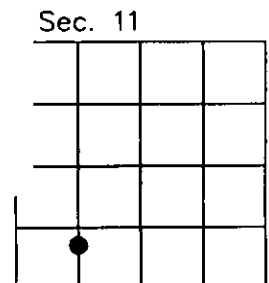

● corner this sheet