

CERTIFIED CORNER RECORDATION

Corner COE 3402 1-6 Sec 11 T. 36N R. 28W P.M.M. Lincoln County

1. Libby Dam - Lake Kookanusa Cadastral 1972 map
2. Found, 3" Corps of Engineers Brass Cap in 4" concrete, stamped as shown.
3. Painted red bands around BTs and attached LSM and BT signs.

Established:

An 11 ins. Douglas Fir bears N76°E, 58.5 ft. distant, scribed "3402-1-6 BT"
A 9 ins. Ponderosa Pine bears S42°W, 8.5 ft. distant, scribed "3402-1-6 BT"
Steel posts with PB & LSM decals, bear East and South, 2.0 ft. distant.

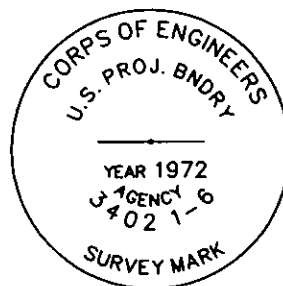

MAGNETIC DECLINATION - 16° EAST

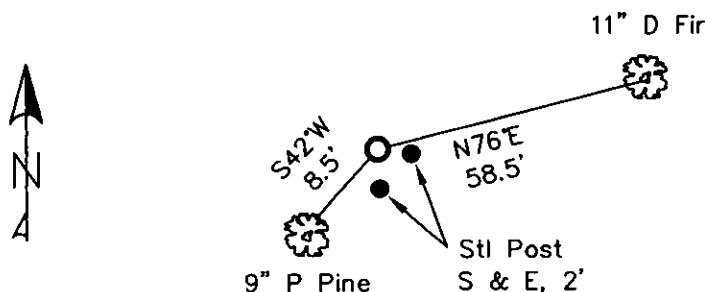

SKETCH OF CORNER

CERTIFICATION

I, ERICH SCHRACK
certify the information shown herein is true and correct.

I, LAWRENCE A. GLAHE
certify that this Corner Record Book represents work performed by me or under my supervision in compliance with the "Corner Recordation Act" (MCA 92-22-401, et seq. M.C.A.)

Date: 12/25/19 9748 LS
Employer: GLAHE & ASSOCIATES, INC.

Office of Clerk and Recorder, County of Lincoln. This "corner

record" was filed for record on 224175 BOOK: CCR CC&R'S PAGE: 11409 Pages: 1

was noted on the cross-index plk STATE OF MONTANA LINCOLN COUNTY
RECORDED: 01/27/2010 3:51 KOI: CC&R'S

book No. TAMMY D. LAUER CLERK AND RECORDER

FEE: \$0.00

BY: [Signature]

TO: FILED

Cross Index No. G-H/19 T. 36N R. 28W PMM

Adopted July 1, 1981, Montana Board of Professional Engineers & Land Surveyors

Sec. 11

● corner this sheet