

CERTIFIED CORNER RECORDATION

Corner COE 3403-2 Sec. 11 T. 36N R. 28W P.M.M. Lincoln County

- 1. Libby Dam - Lake Kookanusa Cadastral 1972 map
- 2. Found, 1 3/8" Copper Disk with "X" stamp in 6" concrete.
- 3. Painted red bands around BTs and attached LSM and BT signs.

Established:

A 12 ins. Western Larch bears N46°W, 18.7 ft. distant, scribed "3403-2 BT"  
A 16 ins. Douglas Fir bears N7°W, 37.5 ft. distant, scribed "3403-2 BT"  
Steel posts with PB & LSM decals, bear North and West, 2.0 ft. distant.

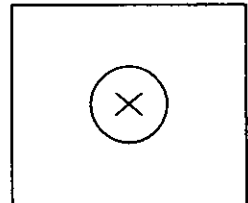

MAGNETIC DECLINATION - 16° EAST

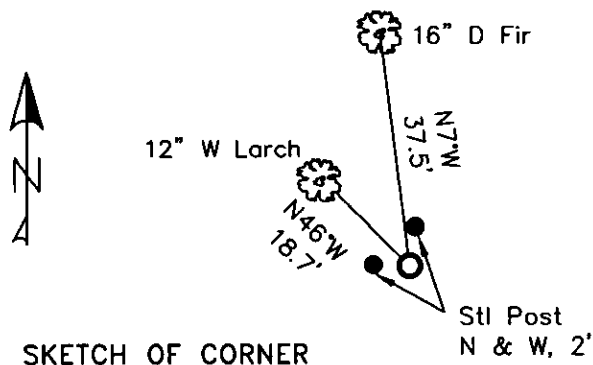

CERTIFICATION

I, ERICH SCHRACK  
certify the information shown herein is true and correct.

LAWRENCE A. GLAHE  
certify that this Corner Recordation represents work performed by me or under my direction in compliance with the "Corner Recordation Act" (MCA 22-1-01, et seq. M.C.A.)

9748 LS  
REGISTERED  
DATE: 1-25-10  
EMPLOYER: GLAHE & ASSOCIATES

Office of Clerk and Recorder, County of Lincoln. This "corner

record" was filed for record on  
was noted on the cross-index  
book No. \_\_\_\_\_

224172 BOOK: CCR CC&R'S PAGE: 11406 Pages: 1  
STATE OF MONTANA LINCOLN COUNTY  
RECORDED: 01/27/2010 3:48 KOI: CC&R'S  
TAMMY D. LAUER CLERK AND RECORDER  
FEE: \$0.00 BY: *[Signature]*  
TO: FILED

Cross Index No. G-20 T. 36N R. 28W PMM

Adopted July 1, 1981, Montana Board of Professional Engineers & Land Surveyors

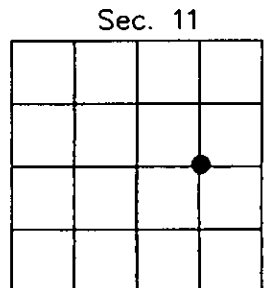

● corner this sheet