

# CERTIFIED CORNER RECORDATION

Corner WC NE SEC 11 T. 36N R. 28W P.M.M. Lincoln County

1. At the Section corner from COE Libby Dam - Lake Koocanusa Cadastral 1972 map, they found a private pipe set by St. Regis.
2. Found 4½" x 4½" concrete monument with 3½" Corps of Engineers brass cap marked as shown, flush with ground.  
A Steel T Post bears South, 1 ft. dist.
3. Exposed the monument and cleared around it. Painted concrete portion of monument.  
Painted red bands around the bearing trees and attached Land Survey Monument and Bearing Tree signs.

Established:

A 9" Douglas Fir bears N44°E, 15.60 ft. dist. scribed "T36N R28W S12 WC BT".  
A 10" Douglas Fir bears S63°W, 18.40 ft. dist., scribed "T36N R28W S11 WC BT".  
A Steel Post with LSM decal bears South, 3.0 ft. dist.

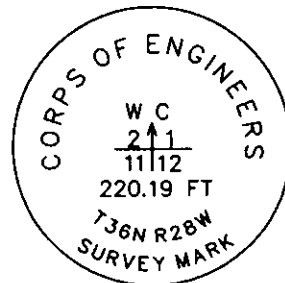

MAGNETIC DECLINATION - 16° EAST

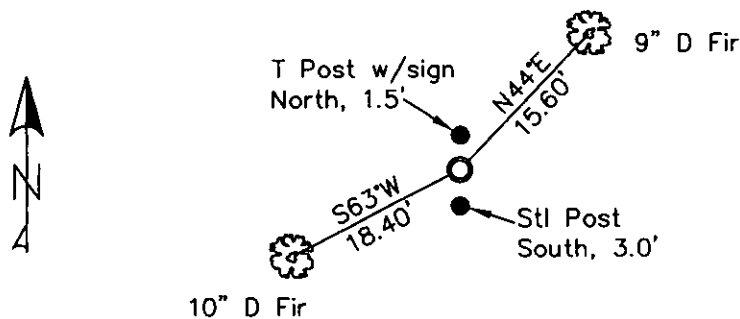

SKETCH OF CORNER

CERTIFICATION  
I, CURT HECKROTH *Curt Heckroth*  
certify the information shown hereon is true and correct.

Signature of Ground Party  
I, LAWRENCE A. GLAHE *Lawrence A. Glahe*  
certify that this Corner Record correctly represents work performed by me or under my direction in compliance with the "Corner Recordation Act" (MCA 92-1-101, et seq. M.C.A.)

9748 LS  
Date: 6-25-10 No. 9748 LS  
Employer: GLAHE & ASSOCIATES, INC.

Office of Clerk and Recorder, County of Lincoln. This "corner record" was filed f 224139 BOOK: CCR CC&R'S PAGE: 11391 Pages: 1  
STATE OF MONTANA LINCOLN COUNTY  
was noted on the RECORDED: 01/27/2010 1:00 KOI: 'CC&R'S  
TAMMY D. LAUER CLERK AND RECORDER  
book No.        FEE: \$0.00 BY: *Tammy D. Lauer*  
TO: FILED

Cross Index No. E-21 T. 36N R. 28W PMM

Adopted July 1, 1981, Montana Board of Professional Engineers & Land Surveyors

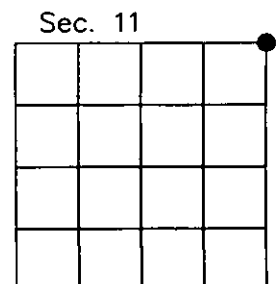

● corner this sheet