

CERTIFIED CORNER RECORDATION

Corner NW Sec. 35 T. 36N R. 28W P.M., MT Lincoln County

- I. 1903 G.L.O. Original Record by Gordon B. Smith et. al.: Set a porphyry stone, 15x8x7 ins., 10 ins. in the ground, for corner of sections 26, 27, 34, and 35, marked with 1 notch on S. and 2 notches on East Edge. Established four bearing trees.

1970 B.L.M. Remonumentation Record by Joseph E. French: The corner of secs. 26, 27, 34 and 35, monumented with a porphyry stone, 15x8x7 ins., firmly set, mkd. with 1 notch on the S. and 2 notches on E. edges, and witnessed by the remains of the original bearing trees. At the corner point, set an iron post, 30 ins. long, 2 1/2 ins. diam., 24 ins. in the ground, with brass cap mkd. as shown.

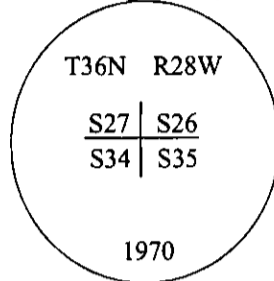

Established two new bearing trees:

A pine, 6 ins. diam., bears S59 3/4°E, 85 lks. dist., mkd. "T36N R28W S34 BT".
A fir, 9 ins. diam., bears N78 1/4°W, 63 lks. dist., mkd. "T36N R28W S27 BT".

Bury the original stone alongside the iron post.

- II. Found a 2 1/2 in. diam. iron pipe, protruding 4 ins. above ground, with a 3 1/4 in. diam. B.L.M. brass cap mkd. as shown.

from which:

A fir, 15 ins. diam., bears N39°E, 40.5 ft. dist., with a healed face. (G.L.O. record)
A fir, 17 ins. diam., bears S45°E, 16.5 ft. dist., with a healed face. (G.L.O. record)
A pine, 13 ins. diam., bears S59°W, 56.1 ft. dist., with a healed face. (B.L.M. record-S59°E)
A larch stump, bears S85°W, 11.2 ft. dist., with "34 BT" visible. (G.L.O. record)
A rotten remains, bears N29°W, 11.2 ft. dist., with 4 "X" mks. visible. (G.L.O. record)
A fir, 15 ins. diam., bears N48°W, 56.8 ft. dist., with a healed face. (No record)
A fir, 13 ins. diam., bears N78°W, 41.6 ft. dist., with visibe scribe. (B.L.M. record)

- III. Painted bearing trees and attached Land Survey Monument and Bearing Tree signs.
Take the main Pinkham Cr. Rd. to cattle guard and fences, go North, 500 ft. along fence to corner.

Magnetic Declination: 20° East

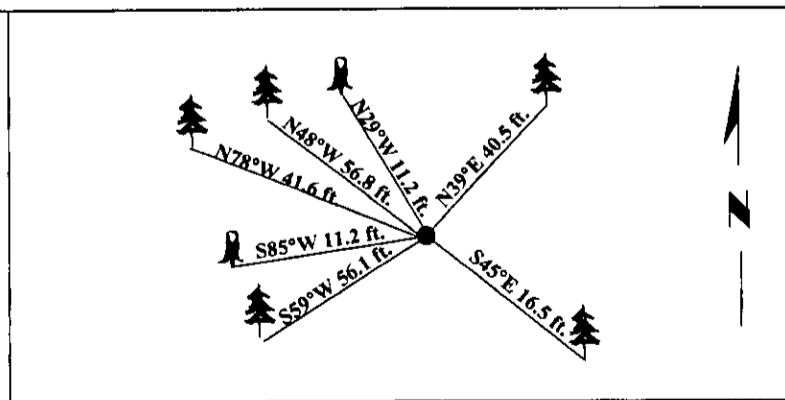

SKETCH OF CORNER

CERTIFICATION

I. Thomas M. Hommel
certify the information shown herein is true and correct.

I. Ronald A. Pearson
certify that this Corner Record correctly represents work performed by me or under my direction in compliance with the "Corner Recordation Act" (70-241, at seq., M.C.A.)

Signature of Surveyor & Seal

Date: 3/16/98

Reg. No.: 9008LS

Employer: U.S. FOREST SERVICE

Office of Clerk and Recorder, County of Lincoln. This "corner record" was filed for record on 7-1-98 and was noted on the cross-index plat and is assigned page No. 10123 in book No. _____.

Coral M. Cummings
County Official

Sec. 35

● - corner this sheet