

# CERTIFIED CORNER RECORDATION

Corner NW Sec. Cor. Sec. 25 T. 36N R. 28W P.M., MT Lincoln County

- I. 1903 G.L.O. Original Record by Gordon B. Smith et. al.: Set a porphyry stone, 14x12x9 ins., 9 ins. in the ground, for corner of sections 23, 24, 25, and 26, marked with 1 notch on East and 2 notches on South edge. Established four bearing trees.

1969 B.L.M. Remonumentation Record by Roy G. Leedy: The corner of secs. 23, 24, 25 and 26, monumented with a porphyry stone, 16x6x8 ins., firmly set, with no visible marks. Witnessed by the remains of the original bearing trees. At the corner point, set an iron post, 30 ins. long, 2 1/2 ins. diam., 24 ins. in the ground, with brass cap mkd. as shown.

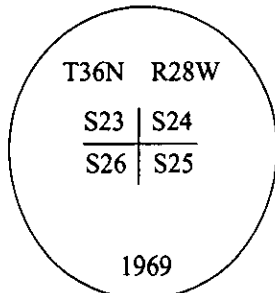

Established four new bearing trees:

- A fir, 6 ins. diam., bears N28°E, 52 lks. dist., mkd. "T36N R28W S24 BT".
- A fir, 6 ins. diam., bears S70 1/4°E, 34 lks. dist., mkd. "T36N R28W S25 BT".
- A fir, 10 ins. diam., bears S15°W, 80 lks. dist., mkd. "T36N R28W S26 BT".
- A fir, 10 ins. diam., bears N86 3/4°W, 33 lks. dist., mkd. "T36N R28W S23 BT".

Bury the original stone alongside and raise a collar of stone, 2.0 ft. diam., around the iron post.

- II. Found a 2 1/2 in. diam. iron pipe, protruding 6 ins. above ground, with a 3 1/4 in. diam. B.L.M. brass cap mkd. as shown.  
from which:

- A pine stump, 36 ins. diam., bears N08°E, 33.0 ft. dist., with visible scribing. (G.L.O. record)
- A pine stump, 14 ins. diam., bears S24°E, 67.3 ft. dist., with visible scribing. (G.L.O. record)
- A fir, 9 ins. diam., bears S70°E, 22.4 ft. dist., with a healed face. (B.L.M. record)
- A fir, 12 ins. diam., bears S15°W, 52.8 ft. dist., with a healed face. (B.L.M. record)
- A fir stump, 24 ins. diam., bears S50°W, 18.5 ft. dist., with visible scribing. (G.L.O. record)
- A pine stump, bears N47°W, 37.4 ft. dist., no visible marks. (G.L.O. record)
- A fir, 13 ins. diam., bears N86°W, 21.8 ft. dist., with a healed face. (B.L.M. record)

- III. Established one new bearing tree:

A fir, 9 ins. diam., bears N54°E, 44.5 ft. dist., mkd. "T36N R28W S24 BT".

Painted bearing trees and attached Land Survey Monument and Bearing Tree signs.  
Magnetic Declination: 20° East

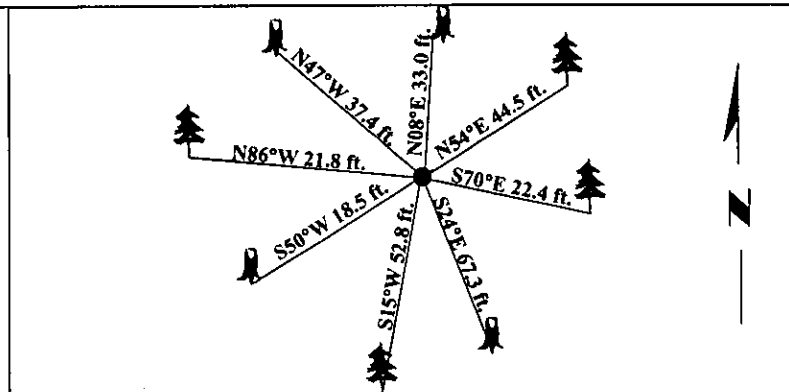

SKETCH OF CORNER

CERTIFICATION

I, Thomas M. Hommel  
certify the information shown herein is true and correct.

I, Ronald A. Pearson  
certify that this Corner Record correctly represents work performed by me or under my direction in compliance with the "Corner Recordation Act" (70-22-101, et seq., M.C.A.)

Signature of Surveyor & Seal

Date: 3/23/98

Reg. No.: 9008LS

Employer: U.S. FOREST SERVICE



Office of Clerk and Recorder, County of Lincoln. This "corner record" was filed for record on 7-1-98 and was noted on the cross-index plat and is assigned page No. 10120 in book No. \_\_\_\_\_.

Coral M. Cummings  
County Official

Sec. 25

● - corner this sheet