

## INSTRUCTIONS

1. Original and/or subsequent record used to evaluate the corner position.
2. Description of evidence found, note discrepancies in the record, state method of establishing lost or obliterated corners.
3. Description of monument and accessories set to perpetuate the corner position.
4. Sketch of corner, show all pertinent data which can best be shown in a sketch example, corner marking, topography ties, position of accessories, etc.
5. Certification must be signed and sealed by Land Surveyor registered in the State of Montana.
6. Fill in Cross Index & Section Diagram at bottom of sheet.

## CERTIFIED CORNER RECORDATION

Corner Cor. of Secs. 28, 29, 32, 33 T. 36 N. R. 27 W. P.M.M. Lincoln County

- I. 1893 original G.L.O. record by Peter McCardell & Abram L. Jaqueth: Set stone and marked four bearing trees.

1969 remonumentation B.L.M. record by Roy G. Leedy: "The cor. of secs. 28, 29, 32 and 33, monumented with a limestone, 14 x 10 x 5 ins., firmly set, mkd. 4 notches on the E. and 1 notch on the S. edges, and witnessed by the remains of the original bearing trees:

- A fir, 16 ins. diam., bears N58°W, 40 lks. dist., mkd. 36N 27W BT.
  - A fir, 16 ins. diam., bears S83°E, 30 lks. dist., mkd. with a rotted blaze.
  - A fir, 16 ins. diam., bears S62 1/2°W, 20 lks. dist., mkd. with an overgrown blaze.
  - A stump, bears N35 1/2°W, 14 lks. dist. with fallen log mkd. S29, lying alongside.
- (Record: N30 1/2°W)

At the corner point

Set an iron post, 30 ins. long, 2 1/2 ins. diam., 16 ins. in the ground, to bedrock, and in a mound of stone, 3 ft. diam., to top, with brass cap mkd.

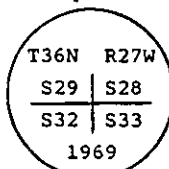

from which

- A fir, 8 ins. diam., bears S33 1/2°E, 70 lks. dist., mkd. T36N R27W S33 BT.
- A fir, 9 ins. diam., bears N5 1/4°W, 69 lks. dist., mkd. T36N R27W S29 BT.

Bury the original stone alongside the iron post."

- II. Found a 2 1/2 ins. diam. iron pipe, 10 ins. out of ground with 3 1/4 ins. diam. B.L.M. brass cap marked as shown above, from which

- A fir snag, 18 ins. diam., bears N56°E, 26.4 ft. (40 lks.) dist., healed face
- A rotten & burnt stump, bears S83°E, 19.8 ft. (30 lks.) dist., healed face.
- A fir stump, 9 ins. diam., bears S33°E, 46.2 ft. (70 lks.) dist., mkd. T30N R27W S33 BT.
- A fir snag, 16 ins. diam., bears S62°W, 13.2 ft. (20 lks.) dist., visible scribe.
- A fir stump, 12 ins. diam., bears N5°W, 44.8 ft. (68 lks.) dist., no visible scribe.

- III. Established three new bearing trees:

- A fir, 4 ins. diam., bears N81°E, 32.4 ft. dist., mkd. X BT with snow blaze.
  - A larch, 3 ins. diam., bears S2°E, 22.6 ft. dist., mkd. X BT with snow blaze.
  - A larch, 4 ins. diam., bears N82°W, 53.5 ft. dist., mkd. X BT with snow blaze.
- No trees available in Sec. 33.

Painted red bands around the bearing trees and attached Land Survey Monument and Bearing Tree signs.  
Set a 6 ft. galvanized steel guard post with Land Survey Marker & Property Boundary decals, West, 3 ft.  
Magnetic Declination: 20° East

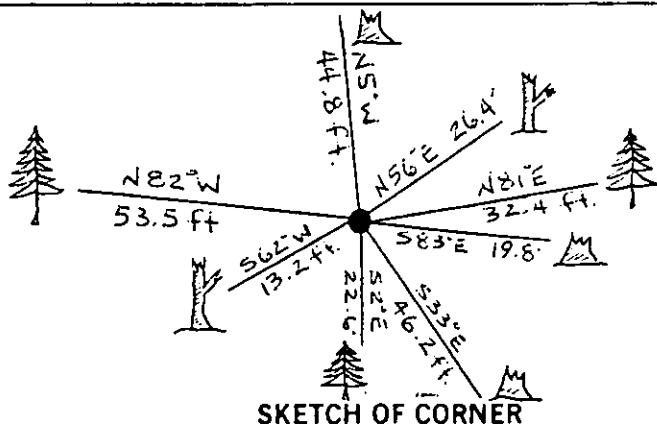

SKETCH OF CORNER

## CERTIFICATION

I, Rex Rice

certify the information shown herein is true and correct.

Rex O. Rice

Signature Ground Party: PEARSON

Ronald A. Pearson

I, Ronald A. Pearson

certify that this Corner Record correctly represents work performed by me or under my direction in compliance with the Montana Corner Recordation Act, 17-2-101, et seq., M.C.A.

Signature of Surveyor & Seal

Date: 11/9/95 Reg. No. 9008LS

Employer: U.S. FOREST SERVICE

Office of Clerk and Recorder, County of LINCOLN. This "corner record" was filed for record on AUG21,1997 was noted on the cross-index plat and is assigned page No. 9965, in book No. CORAL M. CUMMINGS By RLB

County Official

Cross Index No. V-09 T. 36N R. 27W P.M.M.

Sec. 28

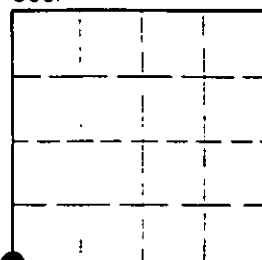

• corner this sheet