

INSTRUCTIONS

1. Original and/or subsequent record used to evaluate the corner position.
2. Description of evidence found, note discrepancies in the record, state method of establishing lost or obliterated corners.
3. Description of monument and accessories set to perpetuate the corner position.
4. Sketch of corner, show all pertinent data which can best be shown in a sketch example, corner marking, topography ties, position of accessories, etc.
5. Certification must be signed and sealed by Land Surveyor registered in the State of Montana.
6. Fill in Cross Index & Section Diagram at bottom of sheet.

CERTIFIED CORNER RECORDATION

Corner 1/4 Cor. Secs. 30 & 31 T. 36 N. R. 27 W. P.M.M. Lincoln County

- I. 1903 original G.L.O. record by Abraham L. Rinearson & Gordon C. Smith: Set stone and marked two bearing trees.

1969 remonumentation B.L.M. record by Roy G. Leedy: "The 1/4 sec. cor. of secs. 30 and 31, monumented with a porphyry stone, 10 x 9 x 6 ins., firmly set, mkd. 1/4 on the N. face and witnessed by the remains of the original bearing trees:

A stump, bears S29 1/2° W, 27 lks. dist., with fallen log mkd. 1/4 S30 BT. (Record: S29 1/2° E)
A stump hole, bears N22 1/2° W, 4 lks. dist.

At the corner point

Set an iron post, 30 ins. long, 2 1/2 ins. diam., 24 ins. in the ground with brass cap mkd.

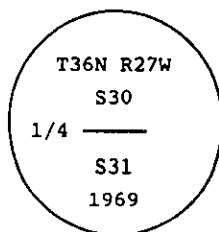

Bury the original stone alongside and raise a collar of stone, 3 ft. diam., around the iron post."

- II. Found a 2 1/2 ins. diam. iron pipe, 3 ins. out of ground with 3 1/4 ins. diam. B.L.M. brass cap marked as shown above

No bearing tree evidence found.

- III. Establish two new bearing trees:

A pine, 3 ins. diam., bears N85° E, 18.6 ft. dist., mkd. X BT with snow blaze.
A pine, 3 ins. diam., bears S19° E, 19.9 ft. dist., mkd. X BT with snow blaze.

Painted red bands around the bearing trees and attached Land Survey Monument and Bearing Tree signs.

Magnetic Declination: 20° East

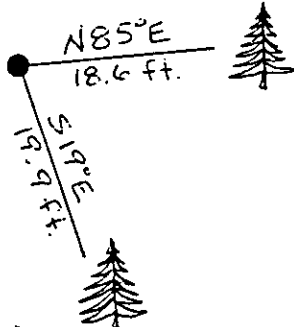

SKETCH OF CORNER

CERTIFICATION

Thomas Hommel

I, Thomas Hommel, certify the information shown herein is true and correct.

Signature Ground Party Chief

Ronald A. Pearson

I, Ronald A. Pearson, certify that this Corner Record correctly represents work performed by me or under my direction in compliance with the "Corner Recordation Act" (70-21-301 et seq., M.C.A.)

Signature of Surveyor & Seal

Date 11/9/95 Reg. No. 9008LS

Employer: U.S. FOREST SERVICE

Office of Clerk and Recorder, County of LINCOLN, This "corner record" was filed for record on AUG 21, 1997 was noted on the cross-index plat and is assigned page No. 994 in book No. CORAL M. CUMMINGS By DEB

County Official

Cross Index No. V-03 T. 36 N R. 27 W P.M.M.

Sec. 30

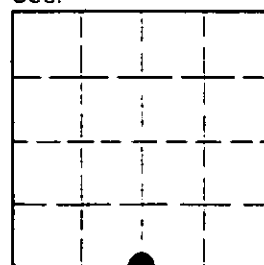

• corner this sheet