

CERTIFIED CORNER RECORDATION

Corner CN 1/16 Sec. 6 T. 36N R. 27W P.M., MT Lincoln County

- I. 1978 Certificate of Survey No. 541 by D.K. Marquardt, Registration No. 2989 ES: Set a 5/8 in. x 24 in. rebar, with plastic cap, stamped "2989 ES".
- II. Found a 5/8 in. diam. rebar, firmly set, protruding 3 ins. above the ground, with a plastic cap mkd. "Marquardt". No bearing trees found.
- III. At the corner point, as determined by the found rebar, set an aluminum rod, 30 ins. long, 3/4 in. diam., 26 ins. in the ground, with a 3 1/4 in. diam. aluminum cap, mkd. as shown, set in a collar of stone.

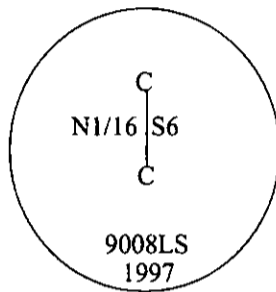

Established two bearing trees and one steel guard post:

- A pine, 15 ins. diam., bears S08°W, 45.1 ft. dist., mkd. "CN1/16 S6 BT".
- A pine, 11 ins. diam., bears S84°W, 24.6 ft. dist., mkd. "CN 1/16 S6 BT".
- A 6 ft. steel post, West, on property line, 3.0 ft. dist from the corner.

Drove the found rebar flush with the ground, alongside the set pipe.

Painted bearing trees and attached Land Survey Monument and Bearing Tree signs.

Attached Land Survey Monument and Property Boundary decals to the post.

Magnetic Declination: 20° East.

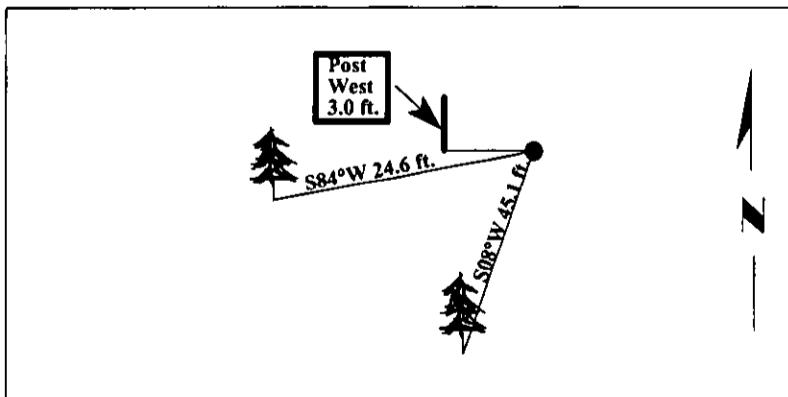

SKETCH OF CORNER

CERTIFICATION

I, Rex O. Rice certify the information shown herein is true and correct.

I, Ronald A. Pearson certify that this Corner Record correctly represents work performed by me or under my direction in compliance with the "Corner Recordation Act" (70-22-101, et seq., M.C.A.)

Signature of Surveyor & Seal

Date: 04/15/97

Reg. No.: 9008LS

Employer: U.S. FOREST SERVICE

Office of Clerk and Recorder, County of LINCOLN. This "corner record" was filed for record on JULY 31, 1997 was noted on the cross-index plat and is assigned page No. 9874 in book No. CORAL M. CUMMINGS By REB

County Official

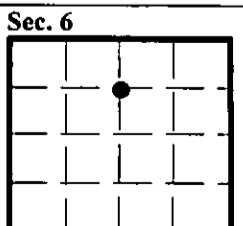

• - corner this sheet