

CERTIFIED CORNER RECORDATION

Corner C.O.E. Sec. 1 T. 36N R. 28W P.M., MT Lincoln County
3803/1

- I. 1972 Corp. of Engineers Libby Dam Lake Koocanusa Cadastral District file No. E 53-1-154; For corner no. 1 of tract 3803, set a standard U.S.C.E. disk, mkd. as shown:

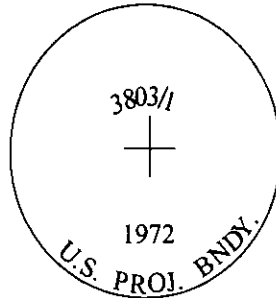

- II. Found a 3 1/2 in. diam., Corps of Engineers brass cap, set in a 4 3/4 in. square concrete pier, 5 ins. above the ground, mkd. as shown above.
- III. Established two bearing trees and set one steel guard post.

A fir, 14 ins. diam., bears South, 74.8 ft. dist., mkd. "CE 1/16 S1 BT".
A pine, 13 ins. diam., bears S70°E, 15.1 ft. dist., mkd. "CE 1/16 S1 BT".
A 6 ft. steel post, North, on property line, 3.0 dist. from the corner.

Painted bearing trees and attached Land Survey Monument and Bearing Tree signs.
Attached Land Survey Monument and Property Boundary decals to the post.

Magnetic Declination: 20° East.

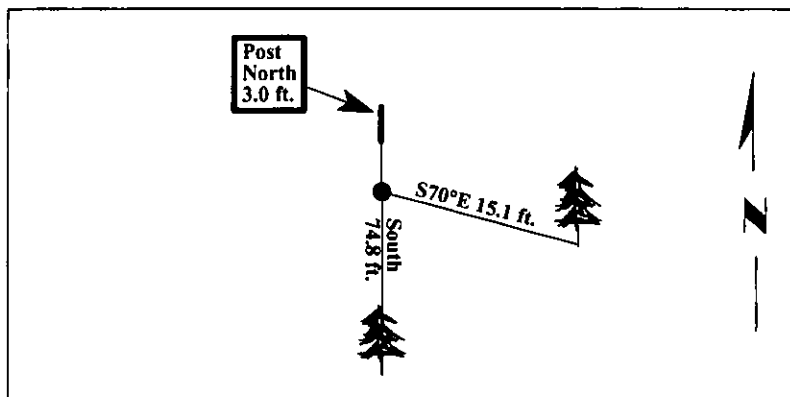

SKETCH OF CORNER

CERTIFICATION

I, Mark Federman
certify the information shown herein is true and correct.

I, Ronald A. Pearson
certify that this Corner Record correctly represents work performed by me or under my direction in compliance with the "Corner Recordation Act" (70-22-101, et seq., M.C.A.)

[Signature]
Signature of Surveyor & Seal

Date: 04/14/97

Reg. No.: 9008LS

Employer: U.S. FOREST SERVICE

Office of Clerk and Recorder, County of LINCOLN. This "corner record" was filed for record on JULY 31, 1997 was noted on the cross-index plat and is assigned page No. 9868 in book No. _____

CORAL M. CUMMINGS
County Official

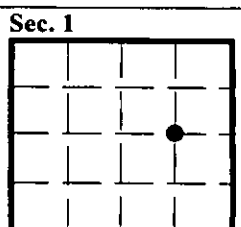

• - corner this sheet

Cross Index No. C.O.E. T. 36N R. 28W P.M., MT
3803/1