

CERTIFIED CORNER RECORDATION

Corner C 1/4 Sec. 6 T. 36N R. 27W P.M., MT Lincoln County

I. 1978 Certificate of Survey No. 541 by D.K. Marquardt Registration No. 2989 ES: Set a 5/8 in. rebar, with a yellow plastic cap, mkd. "Marquardt 2989 ES".

1981 Certified Corner Recordation by Melvin D. Lauteren Registration No. 4232S : Found a 5/8 in. rebar, stamped "2989ES". Buried the found capped rebar, 12 ins. below the ground.

Established two new bearing trees:

A grand fir, 10 ins. diam., bears S15°W, 55.05 ft. dist., mkd. "C 1/4 S6 BT".

A douglas fir, 7 ins. diam., bears N46°W, 63.3 ft. dist., mkd. "C 1/4 S6 BT".

II. Found a 5/8 in. diam. rebar, with a yellow plastic cap, mkd. "Marquardt 2989 ES", firmly set, 8 ins. below the ground surface.

from which:

A fir stump, 12 ins. diam., bears S20°W, 54.8 ft. dist., no visible scribe. (1978-record-S15°W)

A fir stump, 14 ins. diam., bears N44°W, 63.8 ft. dist., no visible scribe. (1978-record-N46°W)

III. At the corner position, as determined by the found rebar, set an aluminum pipe, 30 ins. long, 2 1/2 in. diam., 22 ins. in the ground, surrounded in a 2.0 ft. diam. rock collar, with a 3 1/4 in. diam. aluminum cap, mkd. as shown below:

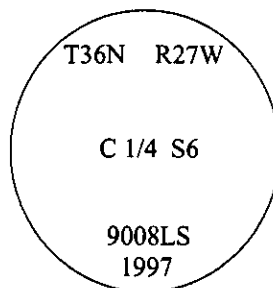

Established two new bearing trees and set two guard posts:

A fir, 11 ins. diam., bears S52°W, 16.55 ft. dist., mkd. "C1/4 S6 BT".

A fir, 14 ins. diam., bears S77°E, 37.7 ft. dist., mkd. "C1/4 S6 BT".

A 6 ft. steel post, West, on property line, 3.0 ft. dist. from the corner.

A 6 ft. steel post, North, on property line, 3.0 ft. dist. from the corner.

Drove the found rebar flush with the ground, alongside the set pipe.

Painted bearing trees and attached Land Survey Monument and Bearing Tree signs.

Attached Land Survey Monument and Property Boundary decals to the posts.

Magnetic Declination: 20° East.

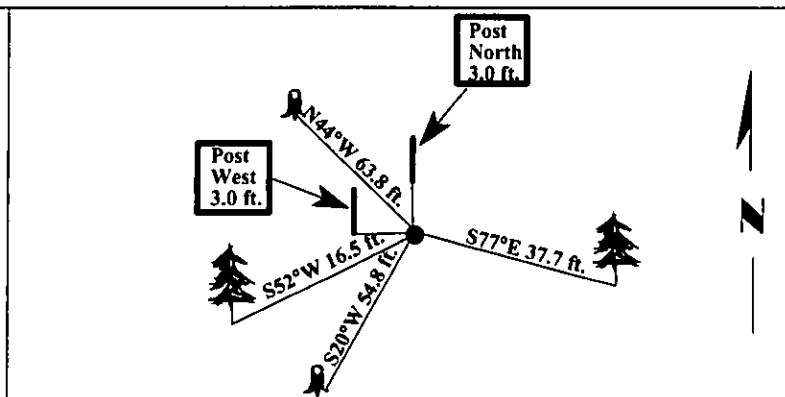

SKETCH OF CORNER

<p>CERTIFICATION</p> <p>I, <u>Rex O. Rice</u> certify the information shown herein is true and correct.</p>	
<p>I, <u>Ronald A. Pearson</u> certify that this Corner Record correctly represents work performed by me or under my direction in compliance with the "Corner Recordation Act" (70-22-101, et seq., M.C.A.)</p> <p><i>[Signature]</i> Signature of Surveyor & Seal</p>	
<p>Date: <u>04/10/97</u></p>	
<p>Reg. No.: <u>9008LS</u></p>	
<p>Employer: <u>U.S. FOREST SERVICE</u></p>	

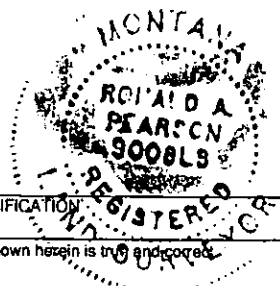

Office of Clerk and Recorder, County of LINCOLN. This "corner record" was filed for record on JULY 31, 1997 was noted on the cross-index plat and is assigned page No. 9867 in book No. CORAL M. CUMMINGS By oib

County Official

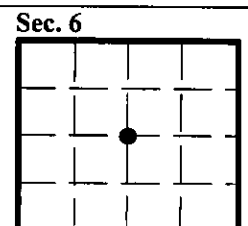

• - corner this sheet