

# CERTIFIED CORNER RECORDATION

Corner W 1/4 Sec. 6 T. 36N R. 27W P.M., MT Lincoln County

- I. 1893 G.L.O. Original Record by Peter McCardell et. al.: Set a post, 3 ft. long, 3 ins. square, 24 ins. in the ground, for 1/4 sec. cor. mkd. "1/4 S" on W. face. Established two bearing trees.
- 1904 Resurvey and Reestablishment record by Abraham L. Rinearson et. al.: Tie the old 1/4 sec. cor. between secs. 1 and 6, which is a post mkd. and witnessed as described in the original record. It will hereafter refer to sec. 6 only.
- 1980 Certified Corner Recordation by Melvin D. Lauteren Registration No. 4232S: Found broken off 4x4 post. At the corner position, as determined by the found post, set an aluminum cap, 8 ins. below the road surface, with cap mkd. as shown below:

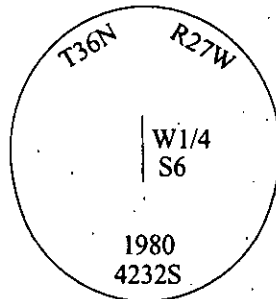

Established two new bearing trees:

- A yellow pine, 10 ins. diam., bears S52°E, 66.10 ft. dist., mkd. "W 1/4 S6 BT".
- A yellow pine, 8 ins. diam., bears N50°30'E, 70.50 ft. dist., mkd. "W 1/4 S6 BT".

- II. Found a 3 1/4 in. diam. aluminum cap, firmly set, 7 ins. below the road surface, mkd. as shown above.

from which:

- A 2 1/2 diam. brass cap, bears S03°W, 42.5 ft. dist., from the corner. (monument for E 1/4 S1)
- A pine, 14 ins. diam., bears S61°W, 65.8 ft. dist., with healed face. (BT for E 1/4 S1)
- A pine snag, 9 ins. diam., bears S52°E, 67.0 ft. dist., with visible scribe. (1980-Record-66.1 ft.)
- A pine, 13 ins. diam., bears N50°E, 70.5 ft. dist., with visible scribe. (1980-Record)

- III. Painted bearing trees and attached Land Survey Monument and Bearing Tree signs.

Magnetic Declination: 20° East.

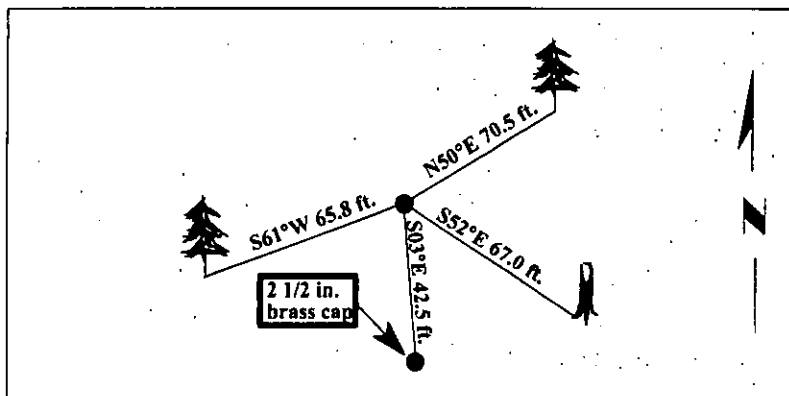

SKETCH OF CORNER

**Mark Federman**  
certify the information shown herein is true and correct.

**Ronald A. Pearson**  
certify that this Corner Record correctly represents work performed by me or under my direction in compliance with the "Corner Recordation Act" (70-22-101, et seq., M.C.A.)

*[Signature]*  
Signature of Surveyor & Seal

Date: 04/10/97

Reg. No.: 9008LS

Employer: U.S. FOREST SERVICE

Office of Clerk and Recorder, County of LINCOLN. This "corner record" was filed for record on JULY 31, 1997 was noted on the cross-index plat and is assigned page No. 9865 in book No. \_\_\_\_\_

**CORAL M. CUMMINGS** *By DMB*  
County Official

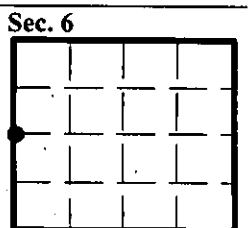

• - corner this sheet