

CERTIFIED CORNER RECORDATION

Corner CS 1/16 Sec. 22 T. 36N R. 27W P.M., MT Lincoln County

- I. 1984 Certificate of Survey No. 1268 by Charles W. Doyle, No. 2516 S: Set a 5/8 in. x 24 in. rebar with plastic cap, stamped "2516 S".
- II. Found a 5/8 in. diam. rebar, firmly set, protruding 3 ins. above the ground, with a 1 1/4 in. diam. yellow plastic cap, stamped "Doyle 2516 S". No bearing trees found.
- III. Accepted the position of the found rebar, and set a 3/4 in. diam. x 30 ins. long aluminum rod, 27 ins. in the ground, with a 3 1/4 in. diam. aluminum cap, surrounded by a small collar of stone, mkd. as shown:

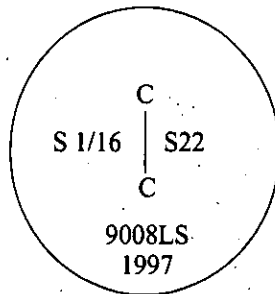

Established two bearing trees and one post:

- A fir, 12 ins. diam., bears S62°W, 27.5 ft. dist., mkd. "CS 1/16 S22 BT".
- A fir, 14 ins. diam., bears S50°E, 89.9 ft. dist., mkd. "CS 1/16 S22 BT".
- A 6 ft. steel guard post, South, on property line, 2.0 ft. dist. from the corner.

Drove the found rebar flush with the ground, next to the aluminum rod.
Painted bearing trees and attached Land Survey Monument and Bearing Tree signs.
Attached Land Survey Monument and Property Boundary decals to the post.

Magnetic Declination: 20° East.

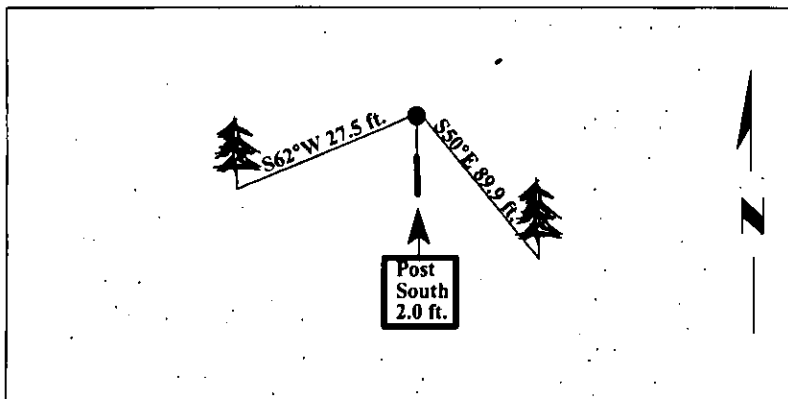

SKETCH OF CORNER

CERTIFICATION **RONALD A. PEARSON**
 I, **Rex O. Rice** certify the information shown herein is true and correct.
 I, **Ronald A. Pearson** certify that this Corner Record correctly represents work performed by me or under my direction in compliance with the "Corner Recordation Act" (70-22-101, et seq., M.C.A.)
 Signature of Surveyor & Seal
 Date: **05/27/97**
 Reg. No.: **9008LS**
 Employer: **U.S. FOREST SERVICE**

Office of Clerk and Recorder, County of **LINCOLN**. This "corner record" was filed for record on **JULY 31, 1997** was noted on the cross-index plat and is assigned page No. **9854** in book No. **CORAL M. CUMMINGS** By **RLB**

County Official

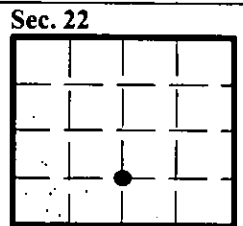

• - corner this sheet