

CERTIFIED CORNER RECORDATION

Corner N.W. Sec. 26 T. 36 N R. 27 W P.M., MT Lincoln County
Cor.

- I. 1893 G.L.O. Original Record by Peter McCardell et. al.: Set a post, 4 ft. long, 4 ins. square, 24 ins. in the ground, for cor. to secs. 22,23,26&27 mkd. "T36N S23" on N.E., "R27W S26" on S.E., "S27" on S.W. and "S22" on N.W. faces with 2 notches on S. and E. edges. Set four bearing trees.
1959-60 B.L.M. Remonumentation Record by David R. Cunningham et. al.: The cor. of secs.22,23,26&27, as determined from the remains of three of the original bearing trees. At the corner point, set an iron post, 30 ins. long, 2 1/2 in. diam., 27 ins. the ground, in concrete, with brass cap mkd. as shown:

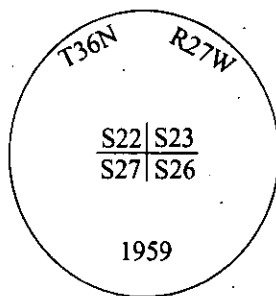

Established four new bearing trees:

- A pine, 8 ins. diam., bears N62 1/2°E, 67 lks. dist., mkd. "T36N R27W S23 BT".
- A fir, 5 ins. diam., bears S37 3/4°E, 57 lks. dist., mkd. "T36N R27W S26 BT".
- A fir, 7 ins. diam., bears S38°W, 21 lks. dist., mkd. "T36N R27W S27 BT".
- A pine, 6 ins. diam., bears N79°W, 70 lks. dist., mkd. "T36NR27W S22 BT".

Raise a mound of stone, 2 1/2 ft. base, 1 1/2 ft. high, W. of the iron post.

1975 Certified Corner Recordation by Jack Ninneman Regulation No. 534 ES: Found a B.L.M. brass cap, witnessed by four bearing trees and one stump.

- II. Found a 2 1/2 in. diam. iron pipe, firmly set, protruding 2 ins. above the ground, with a B.L.M brass cap mkd. as shown above. A rock pile, 2.0 ft. diam., West, 1.0 ft. dist. from the corner.
from which:

- A down pine, bears N64°E, 44.9 ft. dist., with visible scibe. (BLM-record)
- A fir, 9 ins. diam., bears S35°E, 37.8 ft. dist., with a healed face. (BLM-record)
- A pine snag, 29 ins. diam., bears S85°E, 64.0 ft dist., with visible scribe. (GLO-record)
- A pine stump, with a down trunk, 24 ins. diam., bears S25°W, 142.2 ft. dist., with visible scribe. (BLM-record-205 lks.-135.3 ft.)
- A fir, 12 ins. diam., bears S41°W, 13.9 ft. dist., with a healed face. (BLM-record)
- A fir stump, 24 ins. diam., bears N35°W, 36.8 ft. dist., with visible scribe. (GLO-record)
- A fir, 10 ins. diam., bears N76°W, 46.3 ft. dist., with a healed face. (BLM-record)

III. Established one new bearing tree:

A fir, 7 ins. diam., bears N76°E, 43.5 ft. dist., mkd. "T36N R27W S23 BT".
Painted bearing trees and attached Land Survey Monument and Bearing Tree signs.

Magnetic Declination: 20° East.

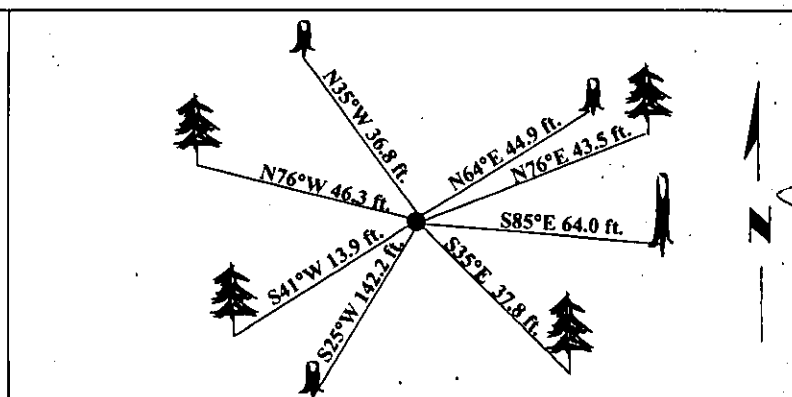

SKETCH OF CORNER

CERTIFICATION

I. Mark Federman
certify the information shown herein is true and correct.

II. Ronald A. Pearson
certify that this Corner Record correctly represents work performed by me or under my direction in compliance with the "Corner Recordation Act" (70-22-101, et seq., M.C.A.)

Signature of Surveyor & Seal

Date: 05/05/97

Reg. No.: 9008LS

Employer: U.S. FOREST SERVICE

Office of Clerk and Recorder, County of LINCOLN. This "corner record" was filed for record on JULY 31, 1997 was noted on the cross-index plat and is assigned page No. 9850 in book No. CORAL M. CUMMINGS By deB

County Official

Cross Index No. R-17

T. 36N R. 27W P.M., MT

Adopted July 1, 1981, Montana Board of Professional Engineers & Land Surveyors

Sec. 26

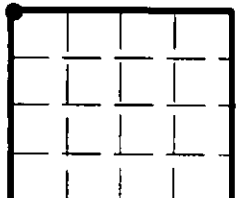

• - corner this sheet